

*I will send an angel before you to guide you on the way
and bring you to the place that I have established.*

Exodus 23:20

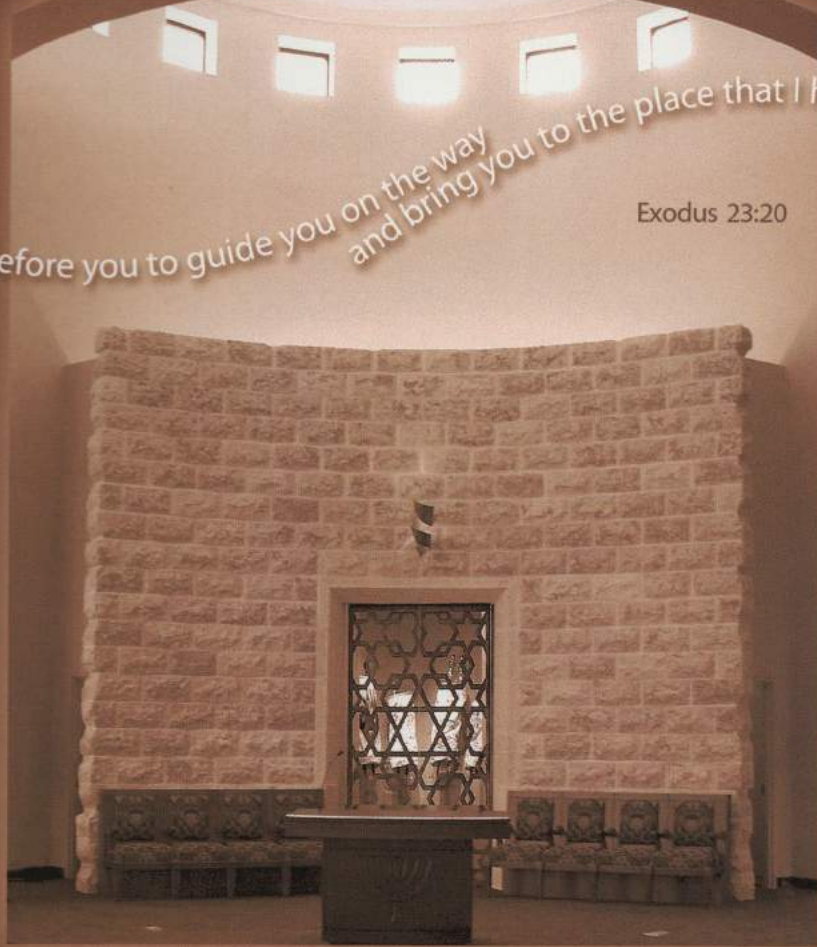

Temple Emanuel Dedication
Greensboro, North Carolina

October 27, 2002
21 Cheshvan 5763

Baruch atah Adonai Elohaynu melech haolam
shehecheyanu v'keeyemanu vehigeeanu lazman hazeh.

ברוך אתה יי אלהינו מלך העולם, שהחיינו וקיימנו והגיענו לזמן הזה.

Praised are You, O Lord our God, Ruler of the world, who has granted us life, sustained us,
and permitted us to celebrate with our family and friends and with each other at this joyous time.

Temple Emanuel Dedication

To remember the past

To live in the present

To trust in the future

[Faint signature]

Sherry D. [unclear]

[Faint text]

*Greetings from
President George W. Bush*



THE WHITE HOUSE
WASHINGTON

September 10, 2002

I am pleased to send greetings to Temple Emanuel as you dedicate your new facility. This event provides a great opportunity for people to tour your new facility, rejoice in your accomplishments, and make plans for the future.

The celebration of faith is central to the lives of all Americans, and the greatness of our Nation lies in the hearts and souls of our citizens. I commend you for the dedicated role you play in your community and for sharing your programs and services with your neighbors.

May your community continue to grow in faith and friendship. Also, may the love that you share with others be a reflection of the common values we all share.

Laura joins me in sending best wishes on this special occasion.

A handwritten signature in black ink, appearing to read "Geo Bush", written in a cursive style.

Dear Congregant,

I am privileged to be president of Temple Emanuel at the dedication of our new facility.

Our new facility is the bridge connecting more than past to present. It connects Jewish individuals to the exploding world of Jewish expression, connects Jewish family with family, and opens our present to future possibility. The image of a river comes to mind, its mysterious currents surfacing as it rolls to some unseen resolution.

Embodied in its eddies are the Judaic themes of time, individual, and family as the collective whole reflects the undying spirit of an ancient people. We now stand on a bridge remembering stories this Judaic river of life carries, wondering what new stories will be told when we are gone.

The original Jewish families that settled in Greensboro put their cultural stamp on the conservative Southern landscape and made life better for all. Our current Temple Emanuel congregation built this facility recognizing a shift in American Jewish life. The new temple provides space to explore and experience the exploding Jewish cultural and religious renaissance. Our new temple links the past with the present world of Judaic thought and spirit.

Our entire congregation met as one on the High Holidays for the first time in many years. The wonderful community spirit that I felt those ten September days demonstrated the power of family interconnectedness.

Let us pause for a moment as we view our new temple. Here we gaze into our future: our children, our children's children, the b'nai Israel, and celebrate this simcha, lovingly aware of l'dor v'dor, generation to generation. Jewish life flows on with many new faces, new dreams, and new possibilities.

This has been a huge undertaking. For the visionaries Tom Sloan, Buzz Strasser and Michael Schifftan; for the many congregational committee members that worked on the project; for the support staff of Temple Emanuel; for the leadership of our rabbi; for the continued passion of the congregation for Judaic spirituality and learning, I say "Thank you! And mazel tov!"

Let us dedicate this new beginning to many older beginnings, remembering and honoring our forebears, our children, our growing community and our prevailing faith. Our new beit kneset beckons. Let our new home be a sacred place where an exciting future can unfold for our entire community. Shalom!



Temple Emanuel President

Sherry Dickstein

*Sherry A. Dickstein, M.D.
President*

It is hard to describe in words my feelings as we dedicate our new campus. Like everything else in life, my feelings begin and end with God. I have always felt that God is the energy that courses through our bodies and makes us shine brightly. Some of the time, when God is a part of what we say and do, we shine very brightly. At other times, when we are estranged from God, we shine less brightly.

Our community is shining very brightly at this moment as we appreciate the ability God gave us to create such a beautiful temple for our future.

I am grateful to God for the opportunity to have been a part of this accomplishment! Seven plus years ago when I first arrived in Greensboro, I could have scarcely imagined this building and campus. My goal was to use whatever God given talents I had to help people become more excited about Judaism, more committed to Torah and God, and more connected to the Jewish people. This was my goal then and it remains my goal to this day.

This congregation did indeed become more excited, committed and connected. It was then that Tom Sloan, Buzz Strasser and Michael Schifftan came forward and provided the initial leadership for this project. Others quickly became excited and the process began.



As in any rich and vibrant community, opinions about how and where to build a new temple were diverse. However, the desire to keep our community together has always been foremost in our hearts and minds. To the credit of this community, we have met the challenges of change with this principle intact.

There are many people who deserve to be thanked for their work and contributions. In reality however, each of us provided a little part of the building and when we step back now and look at the building, we do not see "our part" as much as we see the glory of the whole. Indeed, the beauty of the facility teaches us that the whole community is much larger than the sum of its individuals.

While somewhat illogical, this fact can only be understood when seen in terms of the Presence of God in this project. In truth, people became excited about Torah because Torah is indeed the blueprint for our lives. People became more connected to community because our community shares an inspiring history, a sense of connection to each other in the present and the hope for a glorious future.

Yes, we are shining brightly at present, but we have only just begun to realize the wonderful opportunities that this building and campus give us to increase our knowledge and love of Judaism.

I am in awe of your good works! I am grateful to you for allowing me to become a part of the life of this wonderful community.

Above all, I am grateful to God for inspiring us to have the dream of such a wonderful home and the dedication, fortitude and commitment to bring that dream to fruition.

May God continue to bless us with the ability to dream and implement visions of a great future for Temple Emanuel and Reform Judaism in Greensboro.

When we finish reading the last book of the Torah we say: "Hazak, hazak ve nit-hazek. From strength to strength, may we be strengthened." After saying this phrase, we immediately begin to read from the first part of the Torah. May this incredible building remind us that our learning of Torah should never cease!

May the One who has been so good to us continue to shower upon us blessings of life, health and peace!

Fred Guttman

Rabbi Fred Guttman

Service of Dedication Program

Sounding of the Shofar	Temple Emanuel Shofar Chorale
Torah Processional	Past Presidents of Temple Emanuel, Sisterhood and Brotherhood
Temple Emanuel Greeting	Sherry Dickstein, President, Temple Emanuel
Special Greetings	Representative Howard Coble, 6th N.C. District Keith Holliday, Mayor, Greensboro Rabbi Michael Pont, Beth David Synagogue Nancy Brenner, President, Greensboro Jewish Federation Michael Schifftan, Building Committee Chair Thomas Sloan, Building Committee Chair Richard (Buzz) Strasser, Building Committee Chair
Liturgy for the Service of Dedication	Barry Frank Joanne Bluethenthal Arthur Bluethenthal Sara Lee Saperstein Miriam (Midge) Pines Marc Isaacson
The Significance of this Sanctuary	Rabbi Fred Guttman
In Appreciation of Those Who Went Before	Martin Bernstein Katherine Bernstein
Introduction of Keynote Speaker	John Stern, Vice-Chair, UAHC
Keynote Speaker	Rabbi Eric Yoffie, President Union of American Hebrew Congregations
<i>To Remember the Past</i> Words and Music by Julie Silver	Julie Silver
Recessional to the Entrance Door <i>Sing unto God</i> Music by Julie Silver	Rabbi Fred Guttman Julie Silver
Affixing the Mezzuzah	Rabbi Fred Guttman
Refreshments	Catering by Ellyn
Gala Concert	Julie Silver and Friends

Tributes from Dignitaries



THE FLAG OF THE UNITED STATES OF AMERICA

This is to certify that the accompanying flag was flown over the United States Capitol at the request of the Honorable Jesse Helms, United States Senator,

in honor of

the congregation of
TEMPLE EMANUEL
Greensboro, North Carolina

on the occasion of the dedication of its new facility. The first Jewish congregation in Greensboro, Temple Emanuel was founded in 1907 and has been an integral part of the religious and civic life in Greensboro and across North Carolina.

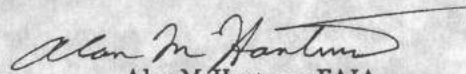
Alan M. Hantman, FAIA
Architect of the Capitol

Temple Emanuel expresses gratitude to
Senator Jesse Helms.

This flag and the framed certificate are permanently
displayed in the lobby of Temple Emanuel.

JOHN EDWARDS
NORTH CAROLINA



United States Senate
WASHINGTON, D. C. 20510

July 15, 2002

Temple Emanuel Dedication Book
C/o Mrs. Ina Eisenberg
5102 Bennington Drive
Greensboro, NC 27410-3415

Dear Friends of Temple Emanuel:

Thank you for writing and informing me about your facility dedication on October 27, 2002. I wish you the best for the future and I hope that you continue to grow through members and through worship. My thoughts and prayers are with all of you. May we look toward the future together and seek guidance and courage through our prayers.

We have so much to be thankful for, yet there is still much more work to accomplish in hopes to provide our children with a better world to live in. I wish all of you the best, and please continue to keep me informed of your future successes.

Yours sincerely,

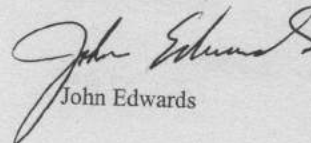
John Edwards

JE/er



Congress of the United States
House of Representatives
Washington, D. C. 20515

October 27, 2002

Howard Coble
Sixth District
North Carolina

Fred Guttman, M.H.L., M.Ed.
Rabbi
Temple Emanuel
713 North Greene Street
Greensboro, North Carolina 27401

Dear Fred:

On behalf of the citizens of the Sixth District of North Carolina, I want to congratulate you and everyone affiliated with Temple Emanuel on the dedication of your new facility. I am sure that the entire Temple Emanuel family is excited and proud of this outstanding addition.

Since 1907, Temple Emanuel has been a beacon of light for Greensboro's Jewish community. The Temple has played a major role in our city's religious and civic life. Members of Temple Emanuel have contributed much to the history of Greensboro, and I am sure the congregation will be key players in the future vitality of our city.

Greensboro is proud to have been the home of Temple Emanuel for nearly a century. We are excited about the new addition to the Temple. I join with everyone gathered today to honor Temple Emanuel's storied past, and we look forward to a bright and prosperous future.

Sincerely,

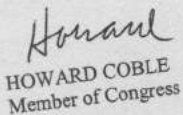
HOWARD COBLE
Member of Congress

*Fred - Best regards to
you and the entire
Temple Emanuel family.*



STATE OF NORTH CAROLINA
OFFICE OF THE GOVERNOR
20301 MAIL SERVICE CENTER • RALEIGH, NC 27699-0301

MICHAEL F. EASLEY

CONGRATULATIONS

It is my privilege to extend greetings and offer my sincere congratulations as *Temple Emanuel* dedicates its new facility on Sunday, October 27, 2002.

This celebration will afford the opportunity to pay tribute to those individuals who laid the foundation for the first Jewish congregation in Greensboro in 1907. Their commitment to excellence will continue to guide you.

As you dedicate your new facility, you have earned this special time of reflection and celebration. While you commemorate your rich history, you may also look forward with great anticipation to your future ministry. May God continue to bless *Temple Emanuel*.

With kindest regards, I remain

Very truly yours,

Michael F. Easley
Michael F. Easley

• RALEIGH, NC • TELEPHONE: (919) 733-5811

Office of the Mayor
City of Greensboro



June 12, 2002

TO: TO THE MEMBERS OF TEMPLE EMANUEL

GREETINGS:

On behalf of the citizens of Greensboro and the City Council, it is my pleasure to express our heartfelt congratulations to *Temple Emanuel* on the dedication of a new facility that will help ensure *Temple Emanuel's* strong role in the lives of its current members and all future generations. You are indeed blessed to be able to celebrate 95 years of service.

Temple Emanuel, founded in 1907, was the first Jewish congregation in Greensboro, North Carolina. The Temple has played a major role in the life of our community.

Greensboro is truly fortunate to have many fine organizations in our community, which provide our citizens with invaluable resources and strength. We wish you the best for a wonderful dedication service as you gather together on Sunday, October 27, 2002.

Sincerely,

Keith A. Holliday

Keith A. Holliday
Mayor

sb

One Governmental Plaza, P.O. Box 3136, Greensboro, NC 27402-3136 (336) 373-2396

October 2002
Cheshvan 5762

Temple Emanuel
Greensboro, NC

Dear Friends:

Congratulations to the families of Temple Emanuel as you dedicate your new facility. I am pleased that I will be with you on October 27th to share in this happy event. As the congregation nears its century mark, this is truly a time to rejoice and celebrate. Your congregation has been an important presence in Greensboro and a center of Jewish life that has anchored the growth of Reform Judaism in the region.

It pleases me to include these words of *mazel tov* in your special dedication journal. In the great tradition of our people, Temple Emanuel now offers a lovely and living house of assembly, study and prayer for the Jewish community. It has enriched the Jewish lives of your members and I pray it will continue to do so for many years to come.

As you gather to dedicate your new home, I know that you will rededicate yourselves to the great ideals of our faith and our people. I pray Temple Emanuel will continue to serve as a vital center of Jewish life and thought and inspire many generations yet to come.

With warm good wishes, I am

Sincerely yours,

Eric H. Yoffie

Eric H. Yoffie

SERVING REFORM JUDAISM
 PHONE: 212.650.41
 FAX: 212.650.41
 633 THIRD AVENUE
 NEW YORK, NY 10017-6778

President
 Rabbi Martin S. Weiner
 San Francisco, CA
 Executive Vice President
 Rabbi Paul J. Menitoff
 New York, NY
 Vice President
 Rabbi Janet Marder
 Los Alamos Hills, CA
 Financial Secretary
 Rabbi Alice H. Dubinsky
 South Portland, ME
 Treasurer
 Rabbi Gustav Buchdahl
 Baltimore, MD
 Recording Secretary
 Rabbi Steven M. Bob
 Lombard, IL
 Membership Secretary
 Rabbi Barton C. Lee
 Tempe, AZ
 Director of Placement
 Rabbi Arnold I. Sher
 New York, NY
 Executive Secretary
 Rabbi Elliot L. Stevens
 New York, NY
 Administrative Director
 Shelley M. Linnner
 New York, NY
 Director of Rabbinic Services
 Rabbi Deborah Papp-Mazo
 Hyannis, MA
 Director of Placement Emeritus
 Brooklyn, NY
 Board Members
 Rabbi Reuven S. Altman
 Rabbi Meir Asari
 Rabbi Herbert M. Baumgard
 Rabbi P. Irving Bloom
 Rabbi Ian M. Brahm
 Rabbi Harry K. Danziger
 Rabbi David Ellman
 Rabbi Stephen D. Franklin
 Rabbi Jonathan H. Gerard
 Rabbi James A. Gilson
 Rabbi Mirak D. Greenstein
 Rabbi Laurence W. Graftman
 Rabbi Stephen A. Hays
 Rabbi Richard J. Jacobs
 Rabbi Allan Krause
 Rabbi Charles A. Kroloff
 Rabbi Dow Marmer
 Rabbi Ralph D. Mecklenburger
 Rabbi Mark J. Pasoff
 Rabbi Sanford Rogins
 Rabbi Elizabeth Rella
 Rabbi Cheryl Rosenstein
 Rabbi Peter Rubinstein
 Rabbi Beth J. Singer
 Rabbi Meva Solfer
 Rabbi Howard F. Sommer
 Rabbi Susan B. Stone
 Rabbi Harvey J. Winkler
 Rabbi Joel I. Winsten
 Rabbi Eric H. Yoffie
 Rabbi Irwin A. Zephowitz
 * * *
 Rabbi Mark Dov Shapiro
 Chair, Convention Program

אגוד הרבנים המתקדמים
 CENTRAL CONFERENCE OF AMERICAN RABBIS
 Founded in 1889
 Office of the Executive Vice President

20 Elul 5762
August 28, 2002

Rabbi Fred Guttman
 Temple Emanuel
 713 North Greene Street
 Greensboro, NC 27401

Dear Fred:

On behalf of the Central Conference of American Rabbis, I extend to you congratulations and best wishes on the dedication of Temple Emanuel's new building. Its successful completion symbolizes the vitality of your congregation and your visionary leadership.

Your congregation, with the guidance of its rabbinic and lay leadership, has enabled the Jews in the community to lead more meaningful Jewish lives. By lovingly conveying the values of Judaism to its children, your congregation has helped to insure a vibrant future for our People. Your congregation also serves as a prominent ambassador of Reform Judaism in the Greensboro area.

The Synagogue is the spiritual home of the Jewish People. We pray that Temple Emanuel will continue to flourish and to enhance the souls of its congregants and the soul of our People.

L'shalom,

Paul Menitoff
Rabbi Paul Menitoff

* * *
 * Save the date: CCAR Convention - March 26-30, 2003 - Washington, DC
 * 355 Lexington Avenue • New York, NY 10017-6603 • 212-972-3636 • Fax: 212-692-0819 • www.ccar.net.org





HEBREW UNION COLLEGE - JEWISH INSTITUTE OF RELIGION
 היברו יוניון קולג' - מכון למדעי היהדות

THE PRESIDENT

August 26, 2002
 18 Elul 5762

Rabbi Fred Guttman
 Temple Emanuel
 1129 Jefferson Road
 Greensboro, NC 27410

Dear Fred,

On behalf of the Hebrew Union College-Jewish Institute of Religion, it gives me the greatest pleasure to salute Temple Emanuel as you dedicate your new facility on Sunday, October 27. I myself have been privileged to experience the hospitality of your community and I know firsthand the blessing your temple has been for the residents of Greensboro. Your synagogue has been a center for Jewish life for almost a century and the leadership and inspiration your rabbis have provided to Jew and gentile alike during this entire period has extended far beyond the borders of Greensboro itself.

I salute you on this auspicious moment in the life of your congregation and know you will continue to grow from strength to strength.

With all best wishes, I am,

Cordially,

David Ellenson
 Rabbi David Ellenson

● Los Angeles
 3077 University Avenue
 Los Angeles, CA 90007-3796
 (213) 749-3424
 fax (213) 747-5901
 e-mail dellenson@huc.edu
 www.huc.edu

● Cincinnati
 3101 Clifton Avenue
 Cincinnati, OH 45220-2488
 (513) 221-1875
 fax (513) 221-0321

● Jerusalem
 13 King David Street
 Jerusalem, Israel 94
 (02) 620-3333
 fax (02) 625-1478



Beth David Synagogue
 Greensboro Conservative Hebrew Congregation, Inc.
 קיץ בית דוד • גרינסבורו, צפון קרוליינה

Rabbi
 Eliezer Havivi

Assistant Rabbi
 Director of Religious
 Education &
 Congregational
 Programming
 Michael Port

Officers

President
 David Altman

President Elect
 Robert Miller

Vice Presidents
 Harry S. Falk
 Harold Gabel
 Susan Nehman
 Josef Silverman

Treasurer
 Howard Mezer

Financial
 Secretary
 Robert Shuman

Recording
 Secretary
 Marian Rudeman

Corresponding
 Secretary
 Marsha Cohen

Board
 of Trustees
 Victor Ackermann
 Steve Almon
 Sylvia Berkehammer
 Bernard Gunerman
 Judith Hyman
 Gali LeSauer
 Michael Nichols
 Kevin Ossey
 Marc Samet
 Louis Silver
 Rob Skarbol
 Beth Socol
 Oier Zmiri

Immediate
 Past President
 Stephen Levy

Sisterhood
 Co-Presidents
 Barbara Herman
 Sonya Lukas

Men's Club
 President
 Alan Socol

Tishre/Cheshvan 5763

Dear Rabbi Guttman and Friends at Temple Emanuel,

Baruch shehecheyanu v'kiymanu v'higiyanu lazeman hazeh - Praised be God who has kept us in life, and sustained us, and enabled us to reach this time.

On behalf of the officers, trustees, and the entire congregation of Beth David Synagogue, it is my pleasure to extend greetings and congratulations upon the dedication of your new home.

May it be God's will that the new campus of Temple Emanuel will serve as:

Beit Tefilla - a house of prayer, where we will give thanks for God's blessings to us;

Beit Kneset - a house of assembly, of sharing of both joy and sorrow, for our community;

Beit Midrash, a house of learning, where all will grow, as individual Jews and as a community, in knowledge of our tradition and love of Torah.

May this structure become a true sanctuary, known to all as *Beit Elohim* - a House of God. May God grant health of body and vigor of spirit to the rabbi and to all members of the congregation. May this new home of Temple Emanuel harbor and inspire reverence, dignity, comfort, peace, sanctity and joy in the years to come.

Shalom,

Eliezer Havivi
 Eliezer Havivi



FEDERATION

OFFICERS

- Nancy Brenner
President
- Jeff Medoff
President Elect
- Neil Belenky
Joanna Caswell
Daniel Gottsegen
Stephen Mackler
Vice Presidents
- Eugene Krusch
Treasurer
- Gary Fischer
Secretary
- Joe Nohman
2003 Men's Campaign Chair
- Catherine Magid
2003 Women's Division Campaign Co-Chair
- Peggy Bernstein
2003 Women's Division Campaign Vice-Chair
- Rachel Cohen
President
Women's Division
- Kathy Manning
Immediate Past President
- Marilyn Forman Chandler
Executive Director
mforman@shalomgreensboro.org
- Phyllis Jerome
Director
Jewish Family Services
jforman@shalomgreensboro.org
- Susan Guterman
Director of Planned Giving
sguterman@shalomgreensboro.org
- Cynthia Scott
Facilities Manager
cscott@shalomgreensboro.org

September 2002
Tishrei 5763

Rabbi Fred Guttman
Dr. Sherry Dickstein, President
Temple Emanuel
1129 Jefferson Road
Greensboro, NC 27410

5509-C West Friendly Avenue
Gulford Corporate Park
Greensboro, NC 27410-4211

336-852-5433
336-852-4346 - Fax
www.shalomgreensboro.org

Dear Temple Emanuel Family:

Mazal Tov on the dedication of your beautiful new building. We know that this unique and wondrous facility will bring tremendous spirit and life to the Temple Emanuel family.

It is written in Psalms: "When ten persons sit together and study Torah, the Shekhinah hovers over them, as it is written, God is present in the divine assembly." May the Shekhinah, God's presence, shine its countenance upon the Temple Emanuel family in the days and years to come. For as the priestly benediction states:

May the Lord bless and protect you.
May the Lord deal kindly and graciously with you.
May the Lord bestow His favor upon you and grant you peace.

For so many years, the Federation and Temple Emanuel shared a common address. We are happy once again to have you near us! We look forward to the future as we continue to work together as partners in building a strong and vibrant Greensboro Jewish community.

Congratulations and Best Wishes!

Sincerely,

Nancy M. Brenner
Nancy M. Brenner
President

Marilyn Forman Chandler
Marilyn Forman Chandler
Executive Director

The Greensboro Jewish Federation serves to foster commitment and resources which strengthen and enrich Jewish life within local, state and national communities.

- BOARD OF TRUSTEES**
- James Adelman*
 - Michael Beckelhammer*
 - Joanne Blumenthal*
 - Steven Bogard
 - Frank Reznar
 - Lawrence Coben*
 - Mansha Cohen*
 - Harvey Calchamán*

- Ben Cone, Jr.*
- Robert Cone
- David Deisman
- Sherry Dickstein
- Jana Fields
- Ellen Fischer
- Richard Forman
- Jon Glazman

- Rick Gray
- Ben Green*
- Jean Guriel
- Bernard Guterman*
- Nancy Guterman
- Rabbi Fred Guttman
- Rabbi Elazer Haviv
- Dina Il'yasov
- Albert Jacobson*

- Leonard Kaplan
- Randall Kaplan
- Robert Lavietes*
- Gail Lebaum
- Jean LeBauer
- Jocelin LeBauer*
- Mimi Levin
- Cathy Levinson
- Stephen Levy

- Joel Lubin
- David Ma
- Ch Ma
- David Me
- Debbie A
- David J
- Susan N
- Susan R
- Kath

- OFFICERS**
- DR. SHERRY A. DICKSTEIN
PRESIDENT
 - MARC L. ISAACSON
PRESIDENT ELECT
 - JOANNE K. BLUMENTHAL
V.P. OF PROGRAMMING
 - DR. ANDREW C. BROD
V.P. OF EDUCATION
 - THOMAS R. SLOAN
V.P. OF OPERATIONS
 - DAVID J. DELMAN
TREASURER
 - DR. LAWRENCE H. GAINS
SECRETARY

- TRUSTEES**
- SUZAN A. ANTH
 - PAUL R. BENSON
 - GAIL I. BERNSTEIN
 - AMY S. CHRYSYAL
 - BENJAMIN CONE, JR.
 - BARRY S. FRANK
 - BRIAN J. GOLDBERG
 - ANGE R. GUTTMAN
 - CRAIG M. KASATOWICK
 - CATHERINE J. MAGID
 - EMILY S. NUDELMAN
 - ANDREA L. PETRARCA
 - MICHAEL S. SCHAFTAN
 - DR. GERRAH D. SCHROENHOFF
 - DESMOND D. SHERIDAN, SR.
 - DR. ROBERT A. WARNER

JEFFERSON ROAD CAMPUS
1129 Jefferson Road
Greensboro, North Carolina 27410
Phone: (336) 292-7899 Fax: (336) 292-6527
templemanuelgso.org



HISTORIC DOWNTOWN CAMPUS
713 North Greene Street

- FRED GUTTMAN, M.H.L., M.E.D.
RABBI
- GERI NEUBURGE
RABBI/C RYTERN
- KAREN E. SPRESSER
DIRECTOR OF RELIGIOUS EDUCATION
- JANETH HATT
DIRECTOR OF PRE-SCHOOL

- GAIL L. HOFFMAN
ADMINISTRATOR
- BRENDA H. BENLEY
DIRECTOR OF CONGREGATIONAL SERVICES
- Laura D. Bonasia
DIRECTOR OF PROGRAMMING
- J. DEAN BLACKBURN
BOOKKEEPER
- MICHELE L. WESTMORELAND
SECRETARY

October 27, 2002

Fellow Congregants:

It is with great pride that we welcome you to our new Temple Emanuel campus.

This historic dedication represents years of personal effort culminating now in the opening of this grand facility. It was not through our efforts alone that this vision became a reality. This was a process and dream of many. We wish to thank those whose spirit guided us, whose resources funded us, and whose time and support enabled us to make the vision a reality.

This new facility, located in a special corner of Greensboro, represents another chapter for our Congregation and for Reform Judaism in our community. Our new Jefferson Road campus together with the historic downtown facility provide Temple Emanuel with renewed opportunities and vitality to grow and embrace our Jewish way of life.

However, this building is only that, a building. It will only become important when it becomes a house of prayer, a sanctuary of spirituality, and a center of Jewish life.

Please join with us in exploring this wonderful new building and in doing so, create your own vision of what this facility should mean to our congregation and to the greater Greensboro community.

In closing, we wish to thank our Rabbi, the Board of Trustees, various committees and individuals who supported us, and our families and friends who made this journey along with us. We could not have done it without you. Thank you.

May God Bless Temple Emanuel

Michael Schiftan *Tom Sloan* *Buzz Strasser*
Michael Schiftan Tom Sloan Buzz Strasser

A proud and rich past propels Temple Emanuel into the future



Temple Emanu-El, Lee Street 1910

Temple Emanuel has been a part of downtown Greensboro's history since 1907, when a group of Jewish citizens met during the High Holy Days in an old grocery store on South Elm Street. The history of Greensboro is intertwined with that of Temple Emanuel, whose Greene Street sanctuary was built in 1923. From the beginning, the congregation and its leaders have been active in Greensboro's social programs and the city's coming of age in business, education, health care and the arts. The relationship between Jewish people and those of other faiths in Greensboro has been strong, unlike those in many other Southern cities. Greensboro News-Record, Sept. 15, 2002

L'Dor V'Dor

The Early Years

- The Reform Hebrew Congregation began in 1907 with Rabbi G. Mendelsohn as the spiritual leader, who served until 1909.
- The congregation met on the second floor of a grocery store at 225 South Elm Street now occupied by Schiffman's Jewelry store.
- Sunday school classes were held in homes of Ceasar Cone, Simon Schiffman, August Schiffman, with David Stern and Bernard Cone as teachers.



August Schiffman



David Stern



Ceasar Cone



Simon Schiffman

- Formal records began with minutes of the board of trustees on February 8, 1908.
- Reform and Orthodox joined together to raise the \$2,500 to purchase the Lee Street property, paid for by January 30, 1910.
- Emanuel Sternberger was elected the first president until 1924. Herman Sternberger was the first treasurer.



Emanuel Sternberger



Herman Sternberger

At different times during Temple Emanuel's 95 year history, the temple housed all three branches of Judaism; hosted USO activities during World War II; produced three rabbis and a cantor; provided space for the Greensboro Special School, Greensboro Day School, B'nai Shalom Hebrew Day School, Greensboro Jewish Federation, and L'Chaim Productions Jewish Theatre Company.

Just as we grew from the vision of our strong-willed and motivated founders who provided for us, now our turn has come to provide for future generations. The privilege of leadership is ours. We must extend our founders' vision and preserve and protect our great heritage for ourselves, our children, and all those who follow. *Our time is now.*

- In 1909, although officially named the Reform Hebrew Congregation, it was commonly known as the Greensboro Hebrew Congregation.

- Land was acquired that is now the Hebrew Cemetery on High Point Road in 1910.

- Louis Egelson was rabbi from 1910 until the middle of 1914.

- J. Friedlaender became the third rabbi from 1914 to 1916.

- During World War I, the congregation was active in fund-raising for war relief.

- Mabel Baach became the pianist in 1915 and later the organist until 1959.

- Simon Cohen was the fourth rabbi from 1916 to 1917.

- Montague Cohen was the fifth rabbi from 1918 to 1919.

■ The Greene Street location was selected in 1918 and the renowned architect Hobart Upjohn was retained. Upjohn later designed First Presbyterian Church and Holy Trinity Episcopal Church, two of the other congregations located in Fisher Park.

- In 1922, with fifty members, construction began on Greene Street. The cornerstone was laid in 1923 and women received full membership.

- Max Kauffman was the sixth rabbi from 1924 to 1925.

- In 1924, Sidney Stern, Sr. was elected president of the congregation and served twenty-two years until 1946.
- Milton Ellis was the seventh rabbi from 1925 to 1930 for the congregation, which had grown to 77 families.
- In 1930, Frederick Rypins became the eighth rabbi, serving the longest term and becoming Rabbi Emeritus in 1959.
- Ruth Rypins assumed an increasing role in the Sunday School until her death in 1974.
- In 1933, Naphtali Kagan was appointed a shochet until his retirement in 1960.
- From the mid-1930's into the 1990's, Min Klein managed an outreach program for Jewish students attending nearby colleges.



*Sigmund Sternberger
Treasurer 1918-1961*

- David Helberg served as Director of the Religious School from 1958 to 1977.
- Arnold Task became the tenth rabbi and served from 1968 to 1989.
- During the 1970's Temple Emanuel, First Presbyterian and Holy Trinity Episcopal developed the Fisher Park Tri-Congregational Social Action Project that included a breakfast club, tutorial program and summer camp for underprivileged children.
- In 1971, land was purchased on Florence Street for building the new religious school.
- In 1973, the congregation, led by Herman Cone, Jr., honored Fannie Love for fifty years of dedicated service.
- In 1977, Min Klein became the first adult bat mitzvah, and Victor Cohen became the Director of the Religious School.
- In 1978, construction began on the Ruth and Fred Rypins Religious School building, which opened in 1980, and the former education wing was renovated into administrative offices.
- In 1981, the congregation grew to 340 families
- Susan Polinsky was the Religious School Director from 1985 to 1988.

The Middle Years

- During World War II, under the leadership of Nathan Markowitz, and funded largely by Laura W. Cone, the basement was converted into a recreation center for soldiers and their friends based at Greensboro's Overseas Replacement Depot (ORD).
- Temple Emanuel provided facilities for conservative worship in the lower level until Beth David Synagogue opened in 1947.
- In 1949, with 170 families, the congregation was officially renamed Temple Emanuel and construction began on an educational wing and the Sternberger Room.
- By 1958, the congregation had 230 families when Joseph Asher became the ninth rabbi, serving until 1968.



*Left, Temple Emanuel,
Greene Street, 1963.*

*Below, Annual Father-Son-
Daughter Banquet, 1955*

Right, Fannie Love

- Dr. Cheryl Greenberg became the Religious School Director in 1988, serving until 1997.



The Present and the Future

- In 1989, Richard Harkavy became the eleventh rabbi, serving until 1994 when Selig Salkowitz became interim rabbi.
- In 1989, inspired by Bill Stern, Brotherhood began an ongoing relationship with the Greensboro Urban Ministry, where the group prepares and serves food monthly.
- Dinner at Eight, the fashionable and successful fundraiser, premiered in 1993.
- In 1994, Miriam (Midge) Pines became the first female president of the congregation.
- In 1994, Charlotte Hurwitz and Laura Bonasia began to edit and produce in-house the monthly bulletin, the Book of the New Year, and the Annual Memorial Book.
- In 1995, Fred Guttman became the twelfth rabbi, reinvigorating Temple Emanuel with a host of programs and activities.
- In 1995, L'Chaim Productions Jewish Theatre Company debuted at Temple Emanuel.
- Congregants Hour premiered during Yom Kippur services in 1996.
- The first annual Martin Luther King, Jr., Shabbat service was held in 1996, with The Reverend Howard Chubbs of Providence Baptist Church as the guest speaker.
- The first Mitzvah Day in 1996 inspired hundreds of congregants of all ages to do good deeds across Greensboro and at the North Carolina Jewish Home in Clemmons.
- In 1996, Sisterhood conducted the first Women's Seder, celebrating achievements of our matriarchs and raising funds for battered women in Greensboro and Jerusalem. Sylvia Ricketts, director of the Friendship Circle, retired; Marilyn Belenky became the new director.
- The first Marriage Reconsecration Service debuted in 1996, allowing couples to celebrate anniversaries and renew vows under a special chuppah.
- In 1995-96, the Mitzvah Crib was introduced. Items are donated to families who cannot otherwise afford them. The March of the Living, led by Rabbi Fred Guttman and comprised of teens from the community, made its

first trip to Israel and Poland.

- In 1998, Karen Dresser became Director of the Religious School.
- On October 21, 1998, the congregation approved a plan to build a new facility on Jefferson Road. A steering committee was formed, and Project Horizon was launched.
- In 1999, Temple Emanuel grew to 475 families.
- Groundbreaking for Project Horizon took place on September 26, 1999.
- The Temple (Greene Street) charter was acquired Nov. 18, 1999; the agreement was signed on June 30, 2000.



- The American Hebrew Academy, our good neighbor on Hobbs Road, opened its doors in September 2001, with 77 students in the entering class.
- In 2001, the Empty Nesters, an adult social group for Temple Emanuel members, was formed.
- The mezzuzah hanging and Torah processional took place at the Jefferson Road campus on September 4, 2002.
- With membership now at approximately 500 families, the first Rosh Hashanah service was held in the new sanctuary on September 6, 2002.
- The Temple Emanuel Jefferson Road campus was dedicated on October 27, 2002.





Past Presidents of Temple Emanuel

*Emanuel Sternberger	1907-1924
*Sidney Stern, Sr.	1924-1946
*Milton Zaubler	1946-1948
*Herbert Falk, Sr.	1948-1950
*George Blankstein	1950-1952
*Sidney Stern, Jr.	1952-1954
*Herbert Falk, Sr.	1954-1956
*Sidney LeBauer	1956-1958
Martin Bernstein	1958-1960
*Milton Weinstein	1960
*Harold Needle	1960-1962
Stanley Frank	1962-1964
Lawrence Cohen	1964-1966
Marshall Solomon	1966-1968
Henry Isaacson	1968-1970
Raymond Tannenbaum	1970-1972
Herman Cone, Jr.	1972-1974
David Zaubler	1974-1976
Arthur Bluethenthal	1976-1978
Richard Forman	1978-1980
Leonard Guyes	1980-1982
Arthur Sohn	1982-1984
Benjamin Marks, Jr.	1984-1986
Richard Levy	1986-1988
Michael Marshall	1988-1990
Thomas Cone	1990-1992
Edward Benson	1992-1994
Miriam Pines	1994-1996
Jerrold Pinsker	1996-1998
Neil Belenky	1998-2000
Barry Frank	2000-2002

**Of Blessed Memory*



Excerpts from our former presidents' memories...

(The presidents' complete remarks
can be found in the archives
of Temple Emanuel.)



Martin Bernstein 1958-1960

Rabbi Joseph Asher was employed as Associate Rabbi, to serve briefly with Rabbi Frederick I. Rypins who had been Rabbi of Temple Emanuel for more than 20 years. Rabbi Asher had been Rabbi of the Reform Congregation in Tuscaloosa, Alabama. Fae and Rabbi Asher had two children, Danny and Rafie.

I was fortunate to be president during Rabbi Asher's first two years at Temple Emanuel.

Minutes of a Meeting of the Board of Trustees of Temple Emanuel held on Friday, 9/5/58 in the Sternberger Room at 9:15 P.M. Presiding: Martin M. Bernstein, President.

The matter of the Greensboro Special School's use of the Sunday School facilities was brought up. After some discussion, a motion by Lawrence Cohen, seconded by Harold Needle that "The Board of Trustees give its consent to the Special School to use our Sunday School for a period of one year". The motion was carried.

Minutes of a Meeting of the Board of Trustees of Temple Emanuel held on Friday, 10/3/58 in the Sternberger Room at 9:00 P.M. Presiding: Martin M. Bernstein, President.

To honor the living widows of two of the original founders of Temple Emanuel on their fiftieth year as members, it was decided to award Mrs. Ceasar Cone, Sr. and Mrs. Simon Schiffman with a special Fiftieth Anniversary scroll at the 10/22/58 congregational dinner.

Brotherhood Report dated 10/22/58, Respectfully submitted by Lawrence M. Cohen, President of Temple Emanuel Brotherhood.

Our Vice President and Program Chairman, Arthur Bluethenthal arranged a fine schedule of programs for the year, which included, Harry Golden, Jonathan Daniels, the Golf Night Dinner, the Father-Son-Daughter Dinner and others.

Minutes of a Meeting of the Board of Trustees of Temple Emanuel held Friday, 1/9/59 in the Sternberger Room at 9:00 P.M. Presiding: Martin M. Bernstein, President.

The President asked the Board's consideration of the question of Rabbi Asher's salary. In the past, the Temple has

made a rent allowance in lieu of parsonage in addition to salary and it was thought advisable that a similar procedure be followed in the case of Rabbi Asher. Thereupon a motion was made by Herman Cone and seconded by Raymond Farber that for the period January 1, 1959, through August 31, 1959, Rabbi Asher's salary be based upon \$7500 annually, and \$1500 rent allowance annually in lieu of parsonage, plus a sum not to exceed \$700 to be paid into the pension fund.

Minutes of a Meeting of the Board of Trustees of Temple Emanuel held Friday, 4/10/59 in the Sternberger Room at 9:15 P.M. Presiding: Martin M. Bernstein, President.

Miss Elizabeth Rockwell noted that Mabel Baach was retiring on May 31 after 45 years of uninterrupted service as organist of Temple Emanuel and that the Music Committee was seeking a new organist and musical director. It was suggested that a special tribute be presented to Miss Baach at the congregational meeting.

Minutes of a Meeting of the Combined Boards of Trustees of Temple Emanuel (1959-60 and 1960-61) held Friday, 8/12/60 in the Sternberger Room at 9:00 P.M. Presiding: Martin M. Bernstein, President.

Lawrence Cohen made a motion that was seconded by Milton Zauber "that Temple Emanuel employ David Helberg to serve the Religious School as teacher and conduct any other activities as may be deemed necessary by the Rabbi and the Board of Education for the sum of \$800.00 for the Religious School year to begin September 1, 1960." The motion was unanimously carried.



Stanley Frank 1962-1964

I have been asked to review my time as president of Temple Emanuel. One of the highlights of my term of office, as I recall, was the pleasant and comfortable relationship with Rabbi Joseph Asher. He was an outstanding forward-thinking individual of the highest order.

We handled the assassination of President John F. Kennedy in a quiet and sedate manner together with Beth David Synagogue.

We had overflow crowds for the High Holiday services and used closed circuit television in the assembly room for the first time.

The sanctuary underwent considerable renovation, restoration and redecoration.

Minimum dues of \$180.00 per family and \$90.00 for single memberships were established with a generally favorable response.

We began a review of the possibility of securing additional property for future growth.

It was a pleasant and rewarding experience for me, and I am forever grateful.



Lawrence M. Cohen 1964-1966

During my term of office, Temple Emanuel grew to 258 family members. There were 176 children in the religious school. Due to the tremendous growth of

the congregation, it was decided to institute dual services for the 1965 High Holiday services. This practice continued until September 2002.

Eight thousand dollars was spent to improve the Religious School classrooms, the roof and the exterior of the Temple.

Discussion was held concerning the proposed acquisition of the Ward property on Florence Street or the McAllister property on Greene Street. No action was taken.

The Temple hired a student rabbi for the High Holy days to assist Rabbi Joseph Asher in reading the service and conducting the children's services.

It was a privilege to serve Temple Emanuel as president.



Marshall Solomon 1966-1968

In 1966, I had the privilege of being elected President of Temple Emanuel.

Understandably, it is difficult to recall all the many temple matters that occurred thirty-six years ago. I do remember attending a convention of the UAHC in Montreal with Rabbi Joseph Asher and his wife, Fae. At that time, my wife, Dot was president of the Sisterhood of Temple Emanuel, and she represented that organization at the convention.

In addition to usual temple business, Rabbi Asher and I

spent many hours discussing the need for enlargement of our physical facilities. David Zauber, a realtor and member of our congregation, worked diligently to try to acquire land adjacent to the temple but, at that time, none was available. Moving to a different location was never discussed.

Temple Emanuel sponsored a vibrant Boy Scout troop led by Jerry Hyman and Lad Landau, II. It was active for many years.

In 1967, Rabbi Asher informed me that he wanted to resign to become Head Rabbi of Temple Emanuel in San Francisco, California. We were fortunate in having this amazing person with us for ten years. He felt as though it was time for him to accept this new appointment.

It was now up to a search committee to try and find a new spiritual leader. It is difficult to forget a flight to Richmond, Virginia, one stormy Sunday in Stanley Frank's airplane to interview a new rabbi. It rained so hard the wings of the airplane were not visible, and the force of the rain chipped the paint off the nose of the airplane. After interviewing many candidates, we selected Rabbi Arnold Task, who remained rabbi of Temple Emanuel for almost twenty years.

I am grateful to the congregation for giving me the opportunity to represent them for several years.



Henry Isaacson 1968-1970

On September 1, 1968, I was honored to take over as president of the congregation of Temple Emanuel. It was also the day that I drove my next door neighbor and very good friend, Rabbi Joseph Asher, to the Greensboro airport so that he could board a plane to San Francisco, California where he would become the new Rabbi at their Temple Emanuel. I was very concerned about not having filled this position prior to Joe's departure, and I had asked Joe to help me find a talented person to step into his shoes, albeit the large ones that they were. He told me about a young rabbi in Newport News, Virginia, by the name of Arnold Task. It was, however, the interim that I was concerned about—services, funerals, bar and bat mitzvahs and all that goes with being the spiritual leader of a congregation. We struggled through - with the help of many congregants, the UAHC, as well as rabbis from other congregations. We pursued Rabbi Task and his wife, Judy, and finally were able to convince them to come to Greensboro.

During my tenure as president, we realized how inade-

quate our religious school facilities were. We tried desperately to enlarge our Greene Street site to meet those needs, but to no avail. We sought a new site on Hobbs Road and, actually, made a deposit on that land. Then my law partner at that time, Sidney Stern, Jr., persuaded the Frasier family to sell to the Temple their family home across Florence Street, and the idea of the Rypins Building was born. Our deposit on the Hobbs Road land was returned, and the crisis over the need for more religious school space was abated.

Things went along pretty well for the remainder of my term. It was, indeed, a grand experience for me and certainly a great honor to serve as the congregation's leader during that time.



Ray Tannenbaum
1970 - 1972

During my tenure as president of Temple Emanuel, we purchased the property for the Rypins building and proceeded with the plans for the building. I remember

that the women didn't want to have a large kitchen. In fact, they probably wouldn't have wanted any kitchen at all in the Rypins building, because they wanted to give up the cooking and have caterers bring in the food. In the past the women had prepared the meals for our congregational meetings.

Greensboro Day School was started and after being turned down by many churches for free space to house their classes while their building was under construction, the board of Temple Emanuel voted to allow them to use our building without charge. The Greensboro Day School agreed to give a scholarship to a deserving minority student in honor of Temple Emanuel.

The board meetings were changed from after services on Friday nights to another night during the week.



Herman Cone, Jr.
1972-1974

My term as president of Temple Emanuel was in the years of 1972-1974, with Rabbi Arnold Task as our rabbi. The budget for the year 1972 amounted to

\$88,222.17. In September, it came to our attention that our secretary, Brenda Henley, needed a new adding machine, and the request was duly approved by a vote of the board of directors!

In this year, the temple hosted a weekend of musical activities and seminars with the noted musicologist, Max Janowski.

In May, we approved the formation of the Friendship Circle, a program for senior citizens from Temple Emanuel and Beth David Synagogue, to be directed by Sylvia Ricketts.

We regretfully accepted the resignation of Fannie Love as Chair of the Temple Emanuel Membership Committee, a post she had held faithfully for more than fifty years.

In October of 1973, a campaign for \$1,000,000 was initiated for the construction of the Ruth and Fred Rypins Education Building; however, the campaign was cancelled almost immediately because of the October war in Israel. It was recommended that the campaign be delayed until 1975.

I can now look back with much pleasure to my years of service to the Temple Emanuel board.



David Zauber
1974-1976

My term of duty was relatively calm; the usual problems and solutions, such as a budget deficit, building maintenance and a multitude of different opinions occurred.

We did seriously investigate building expansion. We planned, at that time, to expand southward on North Greene Street and create a second story over the assembly room and Sunday school—a good idea that did not materialize. As I recall, some preliminary plans were drawn.

All in all, it was a good and interesting two years. We had an excellent board of trustees, committed and hard-working.



Arthur Bluethenthal
1976-1978

Much was accomplished during those two years, but most memorable was the decision to build a Sunday School building and to honor two very special people,

Rabbi Fred and Ruth Rypins. The activities leading to that accomplishment, in addition to the usual business and challenge of Temple Emanuel leadership, took an inordinate amount of time, but it was worth every minute. After a great deal of debate, we agreed to build; hired an architect; raised the money and shortly after, the Ruth and Fred Rypins Educational Building was started. Joyce Wainer was persuaded to chair the Building Committee while Leah Tannenbaum and Herman Cone, Jr., were co-chairs of the Building Fund Drive.

The Rypins would be pleased to see that our commitment to religious education remains strong and that a new, more

spacious education wing is now available to the sons and daughters of Temple Emanuel members.

The Friendship Circle for senior citizens celebrated its fifth anniversary under the leadership of Sylvia Ricketts and the generosity of the Sternberger Foundation.

Celebration of Temple Emanuel's 70th anniversary took place.

The Sisterhood started a ballroom dance class for our teens.

During my last congregational meeting a clever and humorous skit written by Sandy Forman, Barbara Procton, Bea Karesh and Alice Isaacson marked the conclusion of my presidency. The presidential gavel was turned over to Richard Forman.



Richard Forman 1978-1980

My two years as Temple Emanuel president were the culmination of many (12) years on the board as Brotherhood president, two terms as an elected trustee and 4 years as a vice-president. It was an honor I had wished for long before it came my way. Finally, occupying the Rypins Building, thanks mostly to Arthur Bluethenthal and Bill Starr, after so much time and controversy it was a good start. It was a privilege to lead the dedication ceremony and lay the cornerstone with its 100 year time capsule. The temple operated in the black both of my years as president even without a formal budget. I was lucky to be working with a wonderful board of directors and wise enough to assign most major committee chairmanships to these same elected representatives rather than to outside members as in the past. No longer did board members have no function except to attend meetings and listen to others present committee reports. Now they were called upon to run those committees themselves and as a result board meetings became much more interesting and sometimes even exciting places to be.

Along with first vice-president Leonard Guyes, I represented the temple at the UAHC convention in Toronto, Canada, and heard Rabbi Alexander Schindler's tremendous speech advocating a broad and active outreach program, one that opened up Judaism to the intermarried, the converts, the unaffiliated and most revolutionary of all, the children of Jewish fathers, not just those born to Jewish mothers. This remarkable concept is still only shared by the Reform movement and is outwardly rejected by most other denominations; however, it seemed obvious to me when I first heard it in Toronto as it does to me today that Rabbi Schindler's message is essential to Jewish survival in today's world.

Near the end of my term, the rabbi's contract went to a

congregational meeting which overwhelmingly voted for a multi-year extension. My full description of the congregational meeting can be found in the Temple Emanuel archives.

I stayed on the temple board for six more years as a past president then chairman of the finance committee for a total of 20 years in all, ranking me fourth in historical tenure after Herbert Falk, Sr., Sidney Stern, Sr. and Sigmund Sternberger. I list my name with theirs in deep humility and in memory of my mother, Belle Forman. She is the one who insisted that I spend my first Friday night in Greensboro at a synagogue. I picked the temple out of the phone book and found a home. My only regret is that I won't be there when they open that 100 year time capsule.



Leonard Guyes 1980-82

The highlight of my administration was Temple Emanuel's 75th weekend celebration...after a year of planning. Co-chairs, Leah Tannenbaum (of blessed memory), Louise Falk (of blessed memory) and Kay Stern arranged to have Rabbi Joseph Asher (of blessed memory) conduct our Friday night Shabbat service followed by a wonderful oneg shabbat catered by Temple Emanuel's Sisterhood. Then, for our grand celebration, we had a delightful banquet dinner at Bryan Center featuring Rabbi Alexander Schindler (of blessed memory) as our keynote speaker. A truly great weekend was enjoyed by more than 200 members and special guests. This event was held April 23 and 24, 1982.

Other highlights:

September 1980 - The Temple Board of Trustees approved the purchase of 2.744 acres of land adjacent to our cemetery to enable future expansion. The cost was \$12,000.

January 1981 - The Temple Board of Trustees established a General Endowment Fund, restricted, to be funded by a gift from Herman Cone, Sr. This was an estate of 5,000 shares of Cone Mills stock.

August 1981 - The Temple Board of Trustees formed a Long-Range Planning Committee, chaired by Richard Forman, with the primary purpose aimed at expanding the size of our sanctuary and social hall.

September 1981 - Rabbi Arnold Task reported that there were 326 family members at the Temple with minimum dues of \$500 per family: 213 paid minimum dues, 42 paid above minimum dues, 50 paid below minimum dues, and 21 paid no dues.

December 1981 - The Temple Board of Trustees approved

the plans for condominiums to be built adjacent to the Rypins Building by private investors.

February 1982 - The Temple Board of Trustees voted not to purchase the home next to the Sternberger wing of the Temple for \$90,000.

April 1982 - The Historic District of Fisher Park requested that Temple Emanuel endorse the establishment of an historic district and be a part of the Fisher Park Historic District.

May 17, 1982 - The Temple Board of Trustees approved the Fisher Park Historic District request.

May 23, 1982 - At our annual congregational meeting, a new slate of officers and trustees was elected with Arthur Sohn as president.



**Arthur Sohn
1982-1984**

I had a very good presidential tenure because of the quality of my board. They were committed, hard working volunteers and they helped address every problem

before it erupted into something big in the congregation.

We helped the flow of emotion shift away from Greene Street.

10/82 - Established Sunday School Board of Education consisting of eleven members, including high school aged members.

2/83 - Appointed Long-Range Planning Committee headed by Richard Forman; after studying the major repair work needed, the Temple proposed that we "sell out and relocate to another area in the city."



**Benjamin S. Marks, Jr.
1984-1986**

It was indeed an honor and a pleasure to have served as president for the term 1984 to 1986. No serious issues were encountered during my term and working with

Rabbi Arnold Task and Brenda Henley was a pleasure.

During my term of office, I introduced the "Fair Share" plan of establishing dues, which the congregation has endorsed. Also, during my tenure, additional acreage was purchased for the cemetery.

I look forward to the use of our new facility on Jefferson Road.



**Richard D. Levy
1986-1988**

Anyone becoming president of an organization wants to concentrate on leading the group forward.

My two years were spent almost entirely dealing with two divisive issues: whether to renovate the temple or to move; and whether to change rabbinic leadership.

We narrowly decided to stay on Greene Street. Midge Pines led a group who were vital in overseeing a high-quality renovation. However, because congregants refused to purchase neighboring properties as they became available, only one home on Florence Street was purchased.

It was a difficult time. It took more than 15 years to resolve several major issues so that Temple Emanuel could finally look forward.

We did have one very positive accomplishment: Temple Emanuel Pre-School. I am proud that we gave the necessary help for the school to move forward.



**Michael Marshall
1988-1990**

They said it would be an honor and a privilege. Even so, I had concerns, as I was about to take my place as president of the congregation. I had not grown up

in Greensboro as a member of the temple, I had just turned thirty-nine and I had no strong affiliation with the segments of the congregation. One congregant told me not to worry, the temple practically ran itself, and I wouldn't have to do much during my term.

The day after I was elected I received word that Rabbi Arnold Task, who had served the congregation for almost twenty years, was to be approached with a proposal to leave the congregation. This news came as a complete surprise to me and began one of the most painful and emotionally-charged periods for the congregation and me, personally.

Once Rabbi Task made his decision to depart, the Board focused its efforts on finding a new rabbi. After an exhaustive search process, the congregation voted to hire Rabbi Richard Harkavy, an assistant rabbi at Temple Keneseth Israel in Philadelphia, Pennsylvania.

As my first year as president was drawing to a close, we bade an emotional goodbye to Rabbi Arnold and Judy Task and welcomed Rabbi Rick Harkavy and his family, eagerly looking forward to the next chapter of our congregational life. Expectations were high, and a spirit of goodwill prevailed. I was happy and more than a little

relieved that the second year of my term would be one in which I could share in the "honeymoon" for Rabbi Harkavy. Unfortunately, it was not to be. The board of trustees made every effort to support and help Rabbi Harkavy work through his lack of experience and improve his leadership skills. However, within five years, Rabbi Harkavy would leave the congregation.

During my term as president, we, as a congregation, went through an unprecedented period of upheaval. Yet, I am most proud that we held together; perhaps out of sheer will that Temple Emanuel, as a unified congregation, would not be broken.

As I look back on it, I can honestly say that my term as president was an honor and a privilege.



Tom Cone 1990-1992

The most gratifying part of my presidency of Temple Emanuel from 1990 to 1992 was the willingness of so many congregants to volunteer for so many different assignments, some of which I never thought I could persuade anyone to do.

I would especially like to recall three board members with whom I served, and from whom I drew special inspiration, who have since died. Morris Kiel was a board member and Cemetery Committee chair for many years, and also helped in the broader community to keep alive the memory of the Holocaust and of those (including himself) who liberated the death camps during World War II. I was also fortunate to serve with Leah Tannenbaum, who set an exemplary standard of service. Despite years of hard work for just about every worthy organization in North Carolina and beyond, she remained a steadfast, active, and inspirational member of the Temple community until her recent death. Finally, Herbert Falk, Jr., who also died within the past few months, set the highest standards for himself and those with whom he served. I entered the "leadership track" at Temple Emanuel because of Herbert, and also had the pleasure of being his law partner for over fifteen years. Like Leah, he undertook every challenge with intelligence, determination, and grace.

I was also supported by a wonderful staff who put up with two years of my being perennially late with practically everything. Cheryl Greenberg was able to substantially improve our religious school program and increase our children's knowledge of their religion and heritage. For the youngest children, Janet Hiatt did (and continues to do) a remarkable job with the Temple's preschool. She took over the program in its infancy, so to speak, and turned it into a self-supporting and mature program – one of the finest in Greensboro. I attended the joyous cere-

monies for the first graduating class in May, 1992. Many of you remember our soloist at the time, Gabrielle Jochnowitz Clissold. She stayed with this temple for several years during and after her years at UNC-G, and before attending the HUC-JIR cantorial school.

I was honored to be able to present to Sylvia Ricketts a plaque celebrating "twenty years of exemplary service and dedication to our Congregation as founding director and guiding force of Temple Emanuel's Friendship Circle Senior Adult Group."

1992 was the year we brought the temple into the computer age, converting our records and finances to the computer. In addition, the temple board adopted a coherent and consistent "fair share" dues plan and collection policy. A Long Term Planning Committee, chaired by Mike Marshall, was appointed to investigate the future needs of the temple. It was this committee's work, which ultimately led to the new facilities which we are dedicating today. Some other initiatives that year include The Book of the New Year spearheaded by Corky Segal, and the book and bake sale fundraiser organized by Midge Pines and Mary Berkelhammer.

One of the central commandments of Judaism is to provide for those less fortunate than ourselves – to feed the hungry and house the poor. In early 1992, we initiated a project to co-sponsor the building of an Interfaith Habitat for Humanity house with First Presbyterian Church and Holy Trinity Episcopal Church. This gave us the opportunity to build community both spiritually and concretely. We believe that we were the first interfaith group ever to collaborate on a Habitat House.

It was an honor to serve this congregation because I believe that Temple Emanuel is an organization worth preserving. Ninety-five years ago, a handful of Jews, from Reform to Orthodox, and including ancestors of some of our current members, combined their talents, beliefs, and resources to plant a seed of spirituality which continues to bear fruit. In their farsightedness and generosity, they left a legacy from which we draw benefits even to this day. Greensboro's economic viability and the remarkable, and I think unique, acceptance of Jews into the fabric of our city's community life; the Torah scrolls that we read on Shabbat; even our very religion itself – all these are a part of the legacy that our Temple's founders have left us. It is up to us to nurture this tree of life that has been passed down to us.



Edward Benson 1992-1994

Below are listed some of the highlights of my term in office:

1. When I took office, my first priority

was the budget deficit. A campaign was organized, and we raised enough money to balance the budget.

2. At the 1992 meeting of the Mid-Atlantic Council of the UAHC, I was elected to a four-year term and re-elected in 1996.
3. Mitchel Sommers was hired as soloist to participate in services.
4. The Finance Committee was reorganized into two sub-committees for better efficiency.
5. The Board of Trustees voted unanimously not to renew the rabbi's contract.
6. I appointed a twelve-member Search Committee to select a new rabbi for congregational approval.
7. Rabbi Selig Salkowitz was hired as Interim Rabbi.



Miriam (Midge) Pines 1994-1996

As I took office, Temple Emanuel was in the process of finding a new rabbi. Rather than rush the search committee, the board of trustees hired a retired rabbi, Selig

Salkowitz, who specialized in tending to congregations in flux. He agreed to work on a part-time basis, returning to his home for two-week periods. It was my job to find living quarters and transportation during his time in Greensboro and aid him with the structure and needs of our congregation. During his absence, I saw to it that all rabbinic responsibilities were fulfilled.

Some of the highlights of my term of office are the following:

1. Much of my time was spent trying to balance the budget. Along with Buzz Strasser, Alec Natt, Mike Marshall, and advice from Norm Levin of a Charlotte, North Carolina, congregation; we looked into ways of lowering costs and increasing revenue. We appealed to the UAHC for relief from our dues.
2. For many years, the temple bulletin was produced outside the temple until Charlotte Hurwitz and Laura Bonasia began to edit the bulletin in-house.
3. Year-end 1995, Temple Emanuel came very close to a balanced budget.
4. During my second year, the search committee hired Rabbi Fred Guttman. It was my pleasure to introduce him to our congregation and the community. His energy was boundless so we were able to accomplish projects that had been on hold.
5. Jeanne Tannenbaum chaired the first Personnel

Committee. New positions were created and others defined at Temple Emanuel. Brenda Henley became Finance Director; Dean Blackburn, part-time bookkeeper; Laura Bonasia, part-time Program/Office Director.

6. The congregation approved a constitutional change relating to the composition of the board of trustees. A seat was added, chair of the Pre-School. By eliminating the past presidents of Sisterhood and Brotherhood, the congregation was given the opportunity to elect two at-large members.
7. After many years of work, a joint senior high religious school was approved and financed by Beth David Synagogue, Temple Emanuel and the Greensboro Jewish Federation.
8. L'Chaim Productions, a theatre company which produced Jewish-themed plays, produced its first play in our social hall.
9. Sylvia Ricketts, founder and Director of the Friendship Circle, retired after twenty-five years of service and Marilyn Belenky became the new Director.
10. In 1996, Temple Emanuel not only balanced the budget, but had a surplus of \$7,500.
11. The board of trustees created a committee to investigate the possibilities of either enlarging our facility on Greene Street or move to a new site. No vote was taken during my term, but my last act as president was to ask the congregation to approve and support the construction of a new facility for Temple Emanuel, either at its Greene Street location or a different site yet to be determined. This vote passed.



Jerrold Pinsker 1996-98

Continuing with the trends from previous presidents, the congregation invested financially and spiritually in its commitment to the temple as a synagogue. The

membership, while disagreeing on the physical location of the temple, unanimously agreed on a common vision: the renewal of the synagogue's physical needs, its importance in our social lives and the right of each member to travel a different ritual pathway to spirituality. After honest and open debate, our congregation was able to begin to build a consensus for the future predicated on a compromise plan retaining our historical Greene Street location and the new Jefferson Road facility.

The rabbi implemented services that encouraged diversity in services and traditions. This assists individuals in their

desire to define their own Jewish spirituality, their direct relationship to God without excluding another's separate path. The lay leadership implemented a system of normal and reasonable procedures to control the budgeting, the physical facilities upkeep, expansion of the cemetery and the administrative operations of the congregation. The board of trustees decided most issues with broad consensus support after open, honest debate.

Ultimately, in building upon the accomplishments of the earlier presidents, Temple Emanuel became recognizable as the center of Reform Jewish life with an increasing membership, spiritually diverse services and a congregation committed to a common vision of religious growth.

Neil Belenky 1998 – 2000

I was president of the congregation during the period of the three congregational votes that ultimately resulted in the decision to build the new facility on Jefferson Road. This was a deeply contentious period and my goal was to keep the congregation intact (preventing a split into two congregations). My singular focus was to prevent the protracted process from deteriorating into personal attacks that would destroy the congregation.

Keeping the congregation intact required being successful in accomplishing three distinct objectives: 1) keeping the Board focused on its responsibilities to the entire congregation by avoiding personal attacks; 2) ensuring that the congregation debate focused on the merits of staying on Greene Street vs. moving to a different location; it was imperative that the debate not deteriorate into personal attacks among congregants; and 3) developing a decision-making process would have to be seen as fair. While not everyone was happy with the outcome, we remain a unified congregation.

It is important to me that you honor Tom Sloan, and Richard (Buzz) Strasser who were the true leaders during this historic time. While many deserve credit, these two were the champions. They believed deeply in the "rightness" of the project, overcame discouragement, and crafted the strategy that ultimately broke the deadlock.

The congregation voted three times over a two-year period to resolve the issue. Anecdotally, following the third vote, we were several votes shy of the two thirds vote required to move forward with the building project on a new site. Amy Thompson was a monitor during the vote count and represented the group wanting to stay on Greene Street. She noticed that several votes were accidentally placed in the wrong pile and pointed it out to the group responsible

for counting the vote. After placing the votes in the correct pile, the vote to move passed by eleven votes.

Amy Thompson was passionate about staying on Greene; her values required that she point out the error even though it meant losing a two-year struggle. She is a remarkable human being. There was one other situation that will be forever etched in my brain and my heart. It was the bat mitzvah of Rachel Gains. She had to overcome more challenges than most of us will ever face because she suffers from autism. With the love and encouragement of her adoring parents and support of our wonderful Rabbi Guttman, she performed the most inspiring bat mitzvah I have ever witnessed. She showed us all what is truly important. At the end of the day, it is the people I mentioned in this memo whom I will remember the most. They are my heroes.

Barry Frank 2000-2002



The most significant issues of my presidency would be as follows:

1. revitalizing and increasing programming, with the leadership of Rabbi Fred Guttman, the Board of Trustees and the committee chairs
2. constructing the Jefferson Road campus from beginning to near completion
3. securing the historic Greene Street campus into our bright future
4. creating administrative efficiency during a time of positive growth in the size of our congregation; and
5. increasing pledges for Project Horizon and congregant dues to facilitate our programming and congregants' needs

None of the above would have occurred without Rabbi Fred Guttman's leadership and wisdom to the board and to the executive committee, and the tremendous willingness to serve by our staff and too many volunteers to single out individually.

Thank you for the opportunity to be a part of the wonderful book of our long history and the dedication of our new Jefferson Road campus.



(Archives)

Past Brotherhood Presidents

*Milton Weinstein	1945-1947
*Alvin Hamburger	1947-1949
*Dr. Arthur Freedman	1949-1950
*Max Bloom	1950-1952
*Charles Roth	1952-1954
Martin Bernstein	1954-1956
Lawrence Cohen	1957-1959
Arthur Bluethenthal	1959-1961
David Zauber	1961-1963
Richard Forman	1963-1965
Dr. Howard Wainer	1965-1967
Carl Scheer	1967-1968
Joel Fleishman	1968-1971
Howard Silverstein	1971-1973
Paul Saperstein	1973-1975
Arthur Sohn	1975-1977
Benjamin Marks, Jr.	1977-1979
William Starr	1979-1981
Michael Marshall	1981-1983
Leonard Warner	1983-1985
Henry Gutman	1985-1987
*William King	1987-1988
Gary Grandon	1988-1990
Howard Feller	1990-1992
Dr. Allan Goldfarb	1992-1994
Stanley Meyer	1994-1996
Paul Benson	1996-1998
Jay Eisenberg	1998-2002

*Of Blessed Memory

Past Sisterhood Presidents

- *Bertha Oettinger
- *Helen Schiffman
- *Etta Spier
- *Myrtle Sternberger
- *Ella Ginsburg

1936-46 Council/Sisterhood

- | | |
|-------------------|-----------------|
| *Hattie Oettinger | *Ruth Rypins |
| *Mollie Zauber | *Min Klein |
| *Louise Falk | *Virginia Block |

*Adele Rosenberg	1946-1948
Carolyn LeBauer	1948-1950
*Irene Miller	1950-1952
*Laura Weinstein	1952-1954
Joan Steele	1954-1956
Adelaide Israel	1956-1958
Dorothy Solomon	1958-1960
Marge Camras	1960-1962
*Leah Tannenbaum	1962-1964
Kay Stern	1964-1966
Barbara Levy	1966-1968
Joan Falk	1968-1970
Joyce Wainer	1970-1972
Jackie Igar	1972-1974
*Millie Sang	1974-1975
Elaine Marks	1975-1976
Ina Eisenberg	1976-1978
Marnie Ruskin	1978-1980
Linda Silverstein	1980-1982
Rodna Hurewitz	1982-1984
Midge Pines	1984-1986
Mary Berkelhammer	1986-1988
Jane Rosen-Grandon	1988-1990
Sue Meschan	1990-1992
Susan Kalin and Laura Bonasia	1992-1994
Wendee Cutler	1994-1996
Anita Meyer	1996-1999
Catherine Magid	1999-2001

*Of Blessed Memory

Temple Emanuel Rabbis

- 1908-1910 G. Mendelsohn
- 1910-1914 Louis Egelson
- 1914-1916 J. Friedlaender
- 1916-1917 Simon Cohen
- 1918-1919 Montague Cohen
- 1924-1925 Max Kauffman
- 1925-1930 Milton Ellis
- 1931-1958 Frederick Rypins
- 1958-1968 Joseph Asher
- 1968-1989 Arnold S. Task
- 1989-1994 Richard Harkavy
- 1994-1995 Selig Salkowitz (Interim)
- 1995-Present Fred Guttman



Egelson



Cohen



Ellis



Rypins



Asher



Task



Harkavy



Salkowitz



Guttman

The Temple Emanuel experience influenced these people to choose a career as a rabbi or as a cantor.



- (L to R)
 Rabbi Avi (Arnie) Magid
 Rabbi Raphael (Rafi) Asher
 Rabbi Estelle Gottman
 Cantor Gabrielle Jochnowitz Clissold



Sommers

Mitchel Sommers became the Cantorial Soloist for Temple Emanuel in 1991. A New York native, Mitchel received his MFA from UNCG in 1976. In 1989, he became the Community Theatre of Greensboro's Executive Director, a position he still treasures today.

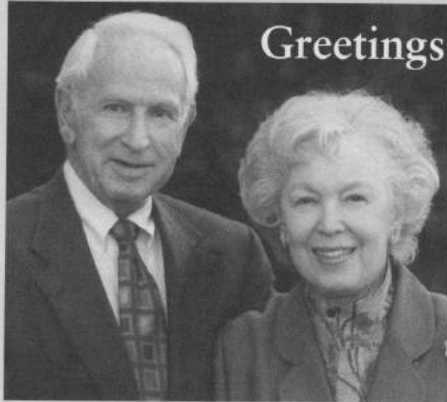

Greetings from Joanne and Arthur Bluethenthal

If the mental stimulation of new challenges is what one needs to remain strong and productive during the seventh decade of life, we should be in tip top shape! Raising the funds to build our new Temple Emanuel campus was one of the most awesome tasks we have ever undertaken. Due to the generosity of our congregants and our friends, and with the assistance of many of them, we reached our goal.

We are proud to be counted among those who helped realize our dream of building an enhanced facility for a fast growing Reform congregation.

Project Horizon Committees

Steering Committee

Co-Chairmen: Tom Sloan and Buzz Strasser
 Fund Raising: Joanne and Arthur Bluethenthal, Polly Strasser
 Facilities: Michael Schifftan
 Recognition Programs: Miriam (Midge) Pines
 Communications: Ivan Cutler
 Professional: Mike Marshall

Program Committee

Co-Chair: Sherry Dickstein
 Co-Chair: Michael Schifftan
 Sanctuary: Jerry Pinsker
 Social Hall/Youth Area: Robert and Emily Nudelman
 Education - Religious School: Marc Isaacson
 Education - TEPS: Erica Procton
 Administrative and Offices: Alec Natt
 Kitchen: Marilyn Belenky
 Mechanical Systems: Paul Levy
 Grounds: Doug Torn
 Interior Design Chair: Sara Lee Saperstein
 Architectural Design Chair: Linda Sloan

Sanctuary Design Committee

Jerry Pinsker, Chair
 Andy Aronson
 Julian Benjamin
 Susan Bond
 Brian Goldberg
 Allan Goldfarb
 Mandy Lerner
 Corky Segal
 Bob Wineburg

Kitchen Design Committee

Marilyn Belenky, Chair
 Mary Berkelhammer
 Donna Burick
 Wendee Cutler
 Annette Davis
 Rascha Kriegsman
 Elaine Marks
 Miriam (Midge) Pines
 Marnie Ruskin
 Donna Burick, Construction Co-Chair
 Hank Gutman, Construction Co-Chair
 Brad Semon, Construction Co-Chair
 Irving Cohen, Advisor

Construction Committee

Michael Schifftan
 Tom Sloan
 Buzz Strasser

Interior Design Committee

Erica Procton, Co-Chair
 Sara Lee Saperstein, Co-Chair
 Linda Sloan, Co-Chair
 Neil Aberman
 Marge Camras
 Sherry Camras
 Anna Lou Cassell
 Amy Chrystal
 Lee Greene
 Bruce Hirschhaut
 Dori Jalazo
 Catherine Magid
 Corky Segal

Architectural Design Committee

Tom Sloan, Co-Chair
 Buzz Strasser, Co-Chair
 Linda Sloan
 Joann Cassell
 Sherry Dickstein
 Ken Eisenberg
 David Evans
 Barry Frank
 Rabbi Fred Guttman
 Bruce Hirschhaut
 Rodna Hurewitz
 Robert Nudelman
 Erica Procton
 Sara Lee Saperstein
 Michael Schifftan
 Corky Segal
 Gary Silverstein
 Harold Zimmerman

Recognition Programs

Miriam (Midge) Pines, Chair
 Anna Lou Cassell
 Linda Fleishman
 Barry Frank
 Ben Marks, Jr.
 Jerry Pinsker



Michael Schifftan, Buzz Strasser and Tom Sloan

Temple Emanuel Floor Plans

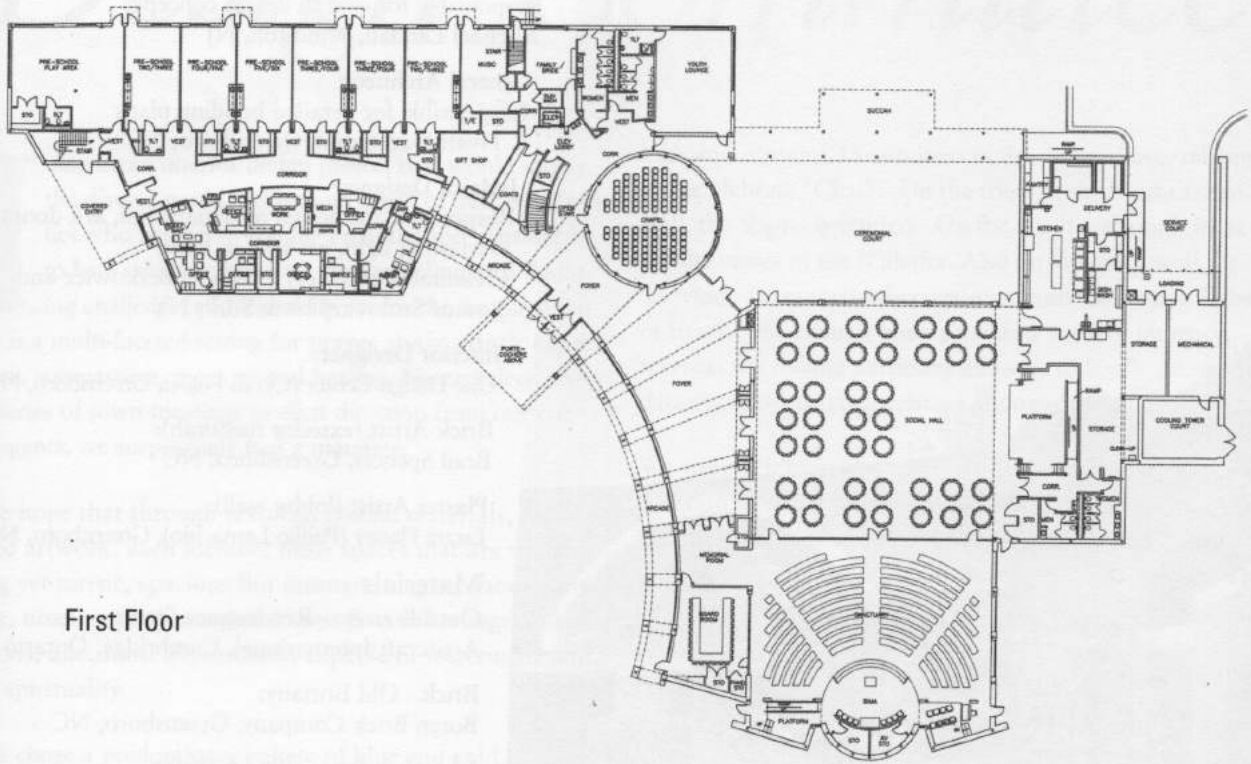

First Floor

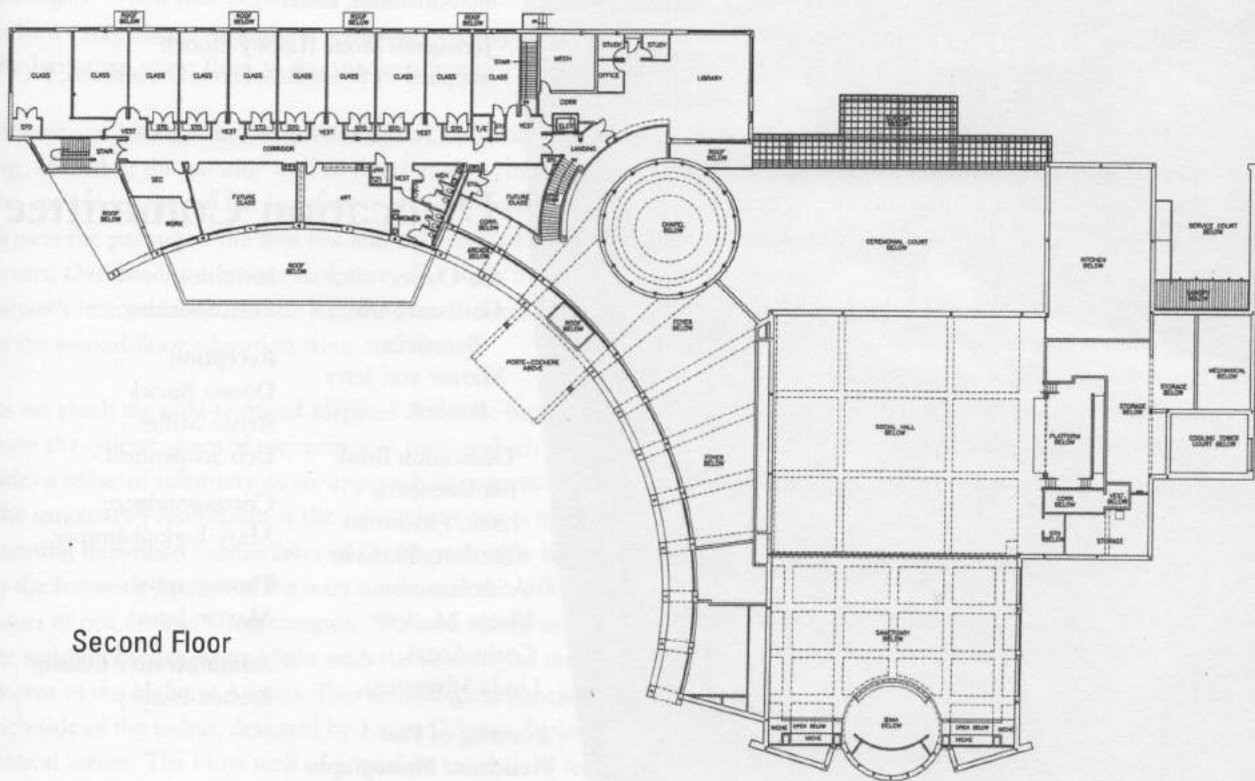

Second Floor

Building Credits

Building Contractor:

Samet Corporation, Greensboro, NC

Design Architect:

Responsible for overall design concept
Michael Landau, Princeton, NJ

General Architect:

Responsible for detailed building plans
J. Hyatt Hammond, Greensboro, NC

Judaica Designer:

Responsible for design of bimah wall, ark doors, everlasting light, art wall in lobby
Presentations Gallery (Michael Berkowicz and Bonnie Srolovitz) New York, NY

Interior Designer:

One Design Center (Cyndi Folds), Greensboro, NC

Brick Artist (exterior menorah):

Brad Spencer, Greensboro, NC

Plaster Artist (lobby wall):

Estate Plaster (Phillip Lamachio), Greensboro, NC

Materials

Outside stone - Renaissance Stone:

Arriscraft International, Cambridge, Ontario

Brick - Old Brittany:

Boren Brick Company, Greensboro, NC

Jerusalem Stone (Bimah Wall):

Ramon Gold, Jerusalem Gardens,
Beit-Shemesh, Israel

Jerusalem Stone (Lobby Floor):

Supplied by Stone Resources, Greensboro, NC

Dedication Committee

Co-Chairs

Gail and Steve

Bernstein

Marnie and Jerry

Ruskin

Dedication Book

Ina Eisenberg

Linda Fleishman

Charlotte Hurwitz

Alice Isaacson

Elaine Marks

Corky Segal

Linda Silverstein

Invitations

Ellen Sheridan

Reception

Donna Burick

Renee Miller

Deb Schoenhoff

Correspondence

Mary Berkelhammer

Photography

Marvin Isreal

Administrative Liaison

Brenda Henley

Framing of Past

Presidents' Photographs

Elaine Marks

Linda Silverstein

Temple • Emanuel *Design Committee*

Imagine an interior design project that would satisfy the diverse needs, desires and tastes of over 500 families who belong to Temple Emanuel and consider it to be a community home. It was definitely a daunting challenge, and rightfully so; for the temple interior is a multi-faceted setting for prayer, study, artistic expression, compassion, memory and healing. Nevertheless, after a series of town meetings to elicit direction from our congregants, we surprisingly had a mandate.

We hope that through textures, colors, materials, lighting and artwork, each member finds spaces that are welcoming yet serene, spacious but intimate, elegant though simple, timeless yet connected to our Jewish heritage and to Israel, and, most importantly, capable of fostering a sense of spirituality.

We chose a predominant palette of blue and gold, significant as it relates to Judaism and the flag of Israel. The mahogany wood trim is rich and warm. And there is symbolism everywhere—beginning with our first steps onto the Jerusalem stone floor in the spacious foyer.

Drawing us inside is an interpretive mural, rich with meaning, affixed to the exterior wall of the chapel. Symbolizing the ancient journey of the Israelites to the Promised Land, it depicts the parting of the Red Sea and the sands of the desert. Overhead is a bronze sculpture, also open to the viewer's interpretation. To the left, the grand staircase leads to the second-floor education wing and library.

As we reach the gold-textured carpeted floor, we begin to enter the quieter space of the memorial room, which provides a sense of solemnity as we approach the sanctuary. The sanctuary's centerpiece is the ark with its doors incorporating burnished bronze Stars of David, strikingly similar to the fretwork pattern of the stars on the wooden ark doors of our Greene Street campus. We look above us to the swirling bronze eternal light with the double yod reminiscent of the Hebrew Adonai. Two stained-glass panels on each side of the pulpit, designed by Karen Dresser, depict biblical scenes. The bima wall of Jerusalem stone is 18 feet

high and contains 18 windows in the dome above, relating to the Hebrew "Chai". On the frieze at the front eastern wall, the Shema is written. On the north and south frieze are the verses of the V'ahafta. Also on the north wall are 12 windows, numerically consistent with the Twelve Tribes of Israel. The circular pews provide a sense of intimacy, whereas the folding partitions allow us to finally accommodate our growing congregation at one seating.

We were determined to design a social hall that would function as a complimentary addition to the sanctuary as well as a space worthy of the many temple and community functions that will undoubtedly take place here. The damask walls, blue and gold patterned carpet, hardwood dance floor, and large chandelier to be added in the future (budget permitting!) will provide an elegant backdrop for these occasions. The room overlooks a spacious ceremonial court, featuring a permanent succah that may be covered to form a chuppa. Behind the social hall, our 1,800 square foot kitchen, designed with the advice of professional caterers, includes walk-in refrigerator and freezer units, multiple warming ovens and a ten-burner stove with two ovens. The circular Chapel stands grandly in the middle of the building. With its light-finished movable furniture, it will provide flexibility for small services and events and will be a unique space with its high ceiling and silver palette.

While we have highlighted in detail the main gathering areas of the building, the education and administrative wing is no less important. The large classrooms and youth lounge, with their primary colors, are particularly fun and bright. The offices, as well as the art and music room, bridal room, library and gift shop are designed to be both functional and attractive.

The Interiors Committee is grateful to the Planning Committee with whom we worked closely and to our professional consultant, Cyndi Folds of One Design Center.

*Erica Procton, Linda Sloan, Sara Lee Saperstein,
Interior Design Committee Co-Chairs*

Excerpts from *Rabbi Fred Guttman's*
Rosh Hashanah
Sermon

5763

*First sermon delivered
in the new sanctuary*

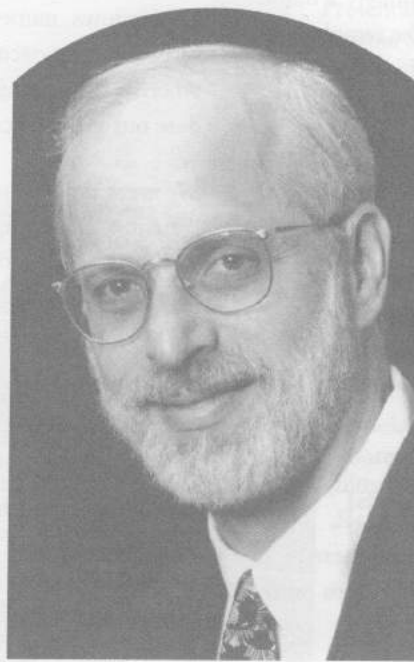

Our entire history has been a history of the community on a journey together. Part of that journey in my family was a man by the name of Jacob Guttman, who, escaping Russian pogroms, came to this country in 1886. Part of that journey were families like the Cones and the Sternbergers. The men of these families collected forty Jewish families and with great foresight, they built a building for a congregation in 1922, building for a congregation that one day would grow to be 200 to 250 families. It was an incredibly visionary dream that the congregation would ever grow that large. Today, by the way, that congregation, this congregation, has 500 families.

We are standing on the shoulders of great women and matriarchs such as Louise Falk and Leah Tannenbaum, both of blessed memory. They helped in no small way to build this congregation and we are the inheritors of its legacy. Each of us is continuing a journey begun by our ancestors a long time ago. As such, we are standing on the shoulders of those who came before us, and we are continuing their journey.

You may not have realized it, but being on a journey is the theme of this building. When you came into this building,

you saw two cornerstones. One is from 1910, and it says on it the words, "Kahal Kadosh Adat Israel", which means, "a holy community, the congregation of Israel." The founders of the congregation on Lee Street set for the congregation the lofty goal of being, "a Holy community within the congregation of Israel."

On the other side of the entrance, you saw our new cornerstone which has on it the dates of this building and the incredible verse from the prophet Micah which states: "It has been told you, O human being, what is good and what the Lord does require of you." In 2002, we have set for ourselves the equally lofty goal of doing justice, loving mercy and being humble before God.

When we walked into the lobby, we saw an incredible interpretive sculpture. Some people say that the brass sculpture represents a "Shin", the word of Shaddai or God Almighty. These letters are found on many mezuzot located on the doorposts of our home. Others say it represents a dove of peace. Some say it represents the Hebrew letter Aleph that which, as the first letter of the alphabet, stands for the unity of God. Still others say it represents a flame. The wall treatment is also open to interpretation. Some say it represents the parting of the sea, while others say it represents the sands of the wilderness.

All of these varied ways of seeing the sculpture teach us that as we go on our journey, we see things differently. We are united as a community, but somewhat diverse in our vision.

On the wall in front of us is a wonderful verse from Exodus that tells us: "Behold, I send an Angel before you, to guide you in the way, and bring you into the place which I have prepared."

We then turn to the right and start walking in the direction of the sanctuary. The outer room of the sanctuary will contain 500 Yahrzeit memorial plaques. Families will be able to purchase Yahrzeit plaques in memory of their loved ones. These plaques will contain the names of our relatives and parents on whose shoulders we are standing and by whose virtue we continue our journey.

Welcome to our new and beautiful sanctuary!

Notice the bima, or the pulpit, is slightly different. It thrusts out and is quite low. The architecture here is meant to say that we are enwrapping one another in our community.

Look to the side and you see the flags of Israel and the United States. As American Jews, we love both countries. This year, we feel very much connected to our fellow Americans especially in the aftermath of the tragedies of this year. We also feel very connected to our brothers and sisters in the land of Israel who seem to live under the constant threat of suicidal and homicidal terror.

Look to the side; you will now see twelve windows. The number twelve is not accidental. It represents the twelve tribes. Yes, each one of us, even if we were not born Jewish, is a member of one of the twelve tribes. Each tribe brings something different to our community, and yet, what makes a community special is when we are all united as are those windows.

Look above us and you will see eighteen windows in the dome. Again, the number eighteen is not accidental. The reason is that the number eighteen represents the Hebrew word, "Chai." It consists of two Hebrew letters one being the yod, the tenth letter of the alphabet, and the second being the het, the eighth letter of the alphabet. Taken together, ten plus eight equals eighteen. These eighteen windows remind us how precious all life is.

Look at the stone wall behind us. It is made of imported Jerusalem stone. It is incredibly beautiful. I think you will agree. Notice that the sides of the wall are somewhat jagged. This is done on purpose and reminds us of a ruin in Israel. We recall that on previous journeys, we have experienced the terror of persecutors and yet we have always rebuilt. In Jerusalem, it is a municipal law that all buildings must be made out of this stone.

The building and the ark face east as synagogues in this country have done from time immemorial. When we pray in this sanctuary, we are facing Israel and the city of Jerusalem. By the way, it is not accidental that the wall is exactly 18 feet high.

On the outside of this dome is a brick menorah and a copy of it is right here in front of me on the front of the lectern. The seven-branch menorah was found in the ancient Temple. Two copies of it were to be found in our Greene Street Sanctuary.

In the ancient Temple, the Menorah symbolized the divine light and presence of God. The center part of the Menorah was kept burning all the time and became known as the "ner tamid", or the eternal light. After the destruction of the Temple in 70 CE, the eternal lamp was moved above the ark as Jews wandered from place to place. The eternal lamp behind me represents both a flame and two yods which spell the name of God. The shape itself can also represent the breath of God.

All around us is this magnificent frieze. It starts with the words of the Shema, and continues with the words of the V'eahavta. "Hear O Israel, the Lord is our God, the Lord is one! You shall love the Lord, your God with all your heart, with all your soul and with all your might." The Ayin in the word, "Shema", and the dalet in the word, "echad", are slightly larger than the other letters. This, by the way, is the way the letters are written in the Torah. The two letters enlarged spell the word, "aid", or witness. Jews are to be witness to the world of the unity of God and to the love for God that all human beings ought to possess.

The words of the Shema and the V'eahavta are put in a mezzuzah, on our doorposts. Above all, these words are to be taught to our children. At our dedication, we will affix a mezzuzah on the entrance to this room. A temporary mez-

zuzah has been affixed to the front door of the building.

Although it is not here now, in a few weeks, we will see four stained glass panels designed by our own Karen Dresser. At the bottom of each one, we will see the parting of the seas in mirror image. On one side at the bottom, we will see a tree of life from the Garden of Eden while on the other side, we will see the burning bush. Above them will be the pillar of fire and the cloud-like pillar that led the people of Israel through the wilderness during the forty years.

This beautiful ark contains Jewish stars, two triangles put together. It is not an accident that the ark doors mimic the ark doors on our Greene Street campus, which also contained the shapes of Jewish stars. In ancient Israel, the Star of David was David's corporate logo. It meant more than that in the Middle Ages. It symbolized the relationship between the Jewish people and God. One triangle coming down to a point symbolizes the divine love that God had for each of us as human beings and as a community. On the second triangle, with the long base going up to the point symbolizes our love for God. When the two triangles are put together, not only is a star formed, but a symbolic description of the mutual relationship between God and the Jewish people.

By the way, the Star of David is also found outside framing the reflecting pool in the traffic circle.

We open the ark and, of course, what is there has been with us all the time on our journey, our sacred Torah, leading us along the way, inspiring us and giving us the courage to continue on our journey.

This incredible building and sanctuary has so many signposts that represent the journey that we are taking both as individuals and as a people.

However, I want you to notice that in our sanctuary, there are no icons. Jews do not have icons in their sanctuary because of the commandment not to create a graven image. What is a "graven image"? A graven image is an image which is not holy.

What is a holy image in Jewish tradition? The answer is,

of course, to be found in the second chapter of Genesis where it says that the human being was created in the image of God.

We have no icons in here because the holy images that are to be put in this beautiful sanctuary and in this beautiful building are you. You are the holy image.

The Torah also tells us that God says to us, "Let them make me a sanctuary that I may dwell among them." This means that all of the architectural things here, as beautiful as they are, are only signposts meant to help us as a community reach a higher level of spirituality.

To make this place holy, however, we need you. We need you to bring your image of God into this sanctuary. Without your presence, the signposts mean little. Without you, we lack community. Without your presence, the presence of God will not be felt, and God will not dwell as the verse says, "among us." When you bring your image here, you help us create community.

Therefore, our journey is not merely a journey of individuals. Rather, it is the journey of a community whose prayers, for the most part, are in the plural. It is a journey of a community which seeks to be supportive and compassionate, a community which tries to nurture one another because they need one another. It is the journey of a community that is diverse, listening, and dedicated to being there for one another. It is a community which is searching for the Promised Land, a community that is standing on the shoulders of those who came before us. It is a community dedicated towards a common journey into the future, a journey in which we hope to find the blessings of God and peace.

Perhaps the most significant aspect of our community and our new building is the fact that the shape of the front represents the shape of open arms. Come join us here this year! Bring your image of God here. Let us give you a spiritual hug! Bless us by your presence as we stand on the shoulders of those who came before us. Together, with God's help, we will continue the sacred journey of our people.

Amen

Project Horizon

Contributors

Debbi and Neil Aberman
Maryann and Stuart Abrahams
Ellen and Jim Adelman
Suzanne Wagner and Michael
Alzheimer
Suzan and Jonathan Antin
Kris and Andrew Aronson
Richard Backer
Laurie and Gary Bargebuhr
Louis Bates
Linda and Scott Bayer
Marilyn and Neil Belenky
Debra and Julian Benjamin
Marilyn and Edward Benson
Susan and Howard Benson
Heather and Paul Benson
Marcia and Alan Berger
Mary Berkelhammer
Sylvia and Mike Berkelhammer
Ellen and Ellis Berlin
Gail and Steve Bernstein
Peggy and Nat Bernstein
Joanne and Arthur Bluethenthal
Linda and Larry Blumenfeld
Laura and Bob Bonasia
Susan and Bob Bond
Nancy and Frank Brenner
Beverly and Larry Brenowitz
Zelda and George Breslow
Andrew Brod
Donna and Paul Burick
Carol and Edmund Burke
Marge and Irv Camras
Sherry and Larry Camras
Charlene and Michael Carr
Anna Lou Cassell
Joann and William Cassell
Sue and Maurice Cawn
Marilyn and Robert Chandler
Amy and Glenn Chrystal
Arlene and Larry Cohen
Harvey Colchamiro
Shelly and David Colin
Sally and Alan Cone
Betty and Ben Cone, Jr.
Hilda Cubell
Sylvia Curtis

Wendee and Ivan Cutler
Annette and Derek Davis
Jane and Mark Davis
Joanna and David Delman
Betty and Kent Dewey
Marion and Jerry Dintenfass
Felicia and Kent Doobrow
Rhonda and David Draper
Karen Dresser
Hilda Dreyer
Karen and Donald Eckstein
Lillian Ehrenreich
Emily and Jay Eisenberg
Ina and Ken Eisenberg
Evelyn Ellsweig
Polly and Steve Ellsweig
Ronald and Petra Emerman
Christine and Justin Evans
Yvonne and David Evans
Ginger and Walter Falk
Belle and Harold Faust
Susan and Scott Feldman
Kathy and Alan Fields
Harriette and Steven Firestone
Ellen and Gary Fischer
Yelizaveta and Abram Fishbeyn
Carole and Jason Flegel
Rhoda Fleisher and Bernie Fleisher*
Linda and Joel Fleishman
Barbara and Dick Forman
Betsy and Richard Fox
Barry Frank
Dorothy and Stanley Frank
Hughlene and William Frank
Dianne and Robert Frank
Kim and Brian Freedman
Marion and Mickey Friedman
Leslie and Larry Gains
Joan and Chuck Ganz
Marsha and Jon Glzman
Wilma and Sheldon Glick
Marlene and Alan Goland
Ria and Brian Goldberg
Terri and Robert Goldberg
Julie and Allan Goldfarb
Shirley Goldklang
Sandy and Erwin Goldman

Howard Goodstat
Sara and David Gordon
Lance Gordon
Susan and Daniel Gottsegen
The Goss Family
Jane Rosen-Grandon and Gary
Grandon
Shawn Evans Greer
Sue and Ronnie Green
Cheryl Greenberg
Joyce and Hank Gutman
Nancy and Bernie Gutterman
Nancy and Fred Guttman
Inge and Otto Guttman
Gayle and Ron Halpern
Dorothy Hamburger
Flora Hanchrow
Beth and Jim Hawkins
Isabel and David Helberg
Lillian Helpert
Janet and David Hiatt
Sharon and Edward Hines
Jackie and Bruce Hirschhaut
Hallee Hogan
Jan and Len Homer
Rodna and David Hurewitz
Charlotte and Mel Hurwitz
Sue and Jerry Hyman
Janice and Stephen Hyman
Jill and Marc Isaacson
Adelaide and Archie Israel
Rita and Aaron Jacobs
Dori and Paul Jalazo
Adrienne and Scott Johnson
Ruth and Craig Kabatchnick
Audrey and Andrew Kane
Tobee and Leonard Kaplan
Kathy Manning and Randall Kaplan
Meg and Richard Kaplan
Cathy and Mark Katz
Alex Katzenstein
Vickie and John Kilimanjaro
Yelena and Mark Kislyanov
Nachman Kodesh
LeeEllen and Robert Koenig
Rascha and Bob Kriegsman
Carmen and Mel Kriegsman

Project Horizon Contributors, continued...

Judy and Jack Kriegsmann
Alana and Franklin Kriegsmann
Judy Frederick and Randy Kritzer
Jeanne and Phil Kusiak
Nat Labell and Helen Labell*
Donna and Jim LaBranche
Sherry Dickstein and Kurt Lauenstein
Gail and Eugene LeBauer
Maina LeBed
Mary and Bob Lee
Lindell and Steven Lehrer
Marilyn Leidner
Mandy and Rich Lerner
Bernice Lerner
Mimi Levin
Stella Levin
Cathy and Henry Levinson
Jane and Richard Levy
Patricia and David Levy
Simone and Joel Liebling
Inessa and Lev Liokumovich
Sonya and Gunner Lukas
Lynn and Kevin MacDonald
Leslie and Stephen Mackler
Lois Magid
Catherine Magid
Sarah and Jonathan Malino
Naomi and Arnold Marks
Elaine and Ben Marks
Annemarie and Edgar Marks
John K. Marks
Nancy and Kelly Marks
Stephen Marks
Kay and Mike Marshall
Linda and J.R. McInnis
Anita and Stan Meyer
Natalie Meyers
Matthew Milch
Martha and Warren Miller
Renee and Lanny Miller
Martha and Ronald Milstein
Lydia and Alan Nadel
JoAnn and Alec Natt
Sam Neerman
Nancy and Lee Novick
Emily and Robert Nudelman
Miriam Ornstein
Estate of Anna Passman
Denise and Michael Peterson
Andrea and Brian Petrarca
Midge and Bill Pines
Susie and Nick Pines

Jerry Pinsker
Deborah Schoenhoff and Jerry Plovsky
Renee and Jack Pollack
Barbara Pomer
Karen and Eric Pomerantz
Barbara and Jerry Procton*
Cathy and Brad Procton
Donna and Donald Pulitzer
Lillian and Al Rauch
Lowell Rauch
Laurie and Norman Regal
Temple Emanuel Religious School
1999-2000 5th Grade Class
Sara and Stephen Robertson
Michelle and Jeffrey Rosen
Ila Rosenthal
Keren and Jay Rotberg
Amanda and Kenny Rotenstreich
Marnie and Jerry Ruskin
Bernice Salvin
Sylvia and Norman Samet
Sara Lee and Paul Saperstein
Lee Schandler
Cindy and Jay Schechter
Lynne and Michael Schifitan
Dana and Stuart Schleien
Laura and Brett Schulman
Jane and Norman Schwartz
Sheila Schwartz and Jack Schwartz*
Mark Schwarz
Anne and Eric Seeley
Helen and Paul Segal
Kim and Philip Segal, III
Corky Segal and Phil Segal, Jr.*
Bernie Seidel
Soloman Seidman
Allan and Cindy Shackelford
Eleanore Shallant
Hope Gruber and Richard Shannin
Joy and Steve Shavitz
Ellen and Desmond Sheriden
Carol and Brian Shore
Sheryl Silver
Janie Silvers
Linda and Howard Silverstein
Betsy and Gary Silverstein
Faye and Paul Simel
Sue and Gary Simmons
Ruth Simon-Newton*
Temple Emanuel Sisterhood
Linda and Tom Sloan
Estate of Edith Sloan
Paula and Frank Sloan

Allison Sloan
Tamara Sloan
Carolyn Sloan
Deane and Seymour Smigrod
Dana and Philip Smith
Lois and Mort Snitzer
Barbara and Arthur Sohn
Dot and Marshall Solomon
Katrina Solomon
Mitchel Sommers
Ethel and Arnold Sookne
Ellen Spear Smith
Ruth and Mack Sperling
Linda and Bill Starr
Kathryn and Joseph Stern
Irwin and Sterra Stovroff
Polly and Buzz Strasser
Aaron Strasser
Joey Strasser
Scott Strasser
Nancy and Paul Summerell
Peggy Tager
Doris and Stanley Tanger
Joan and George Theisen
David and Teresa Tolin
Sandie and Fred Tolin
Carole and Doug Torn
Barbara and Jo Van der Linden
Mary and Scott Van der Linden
Revmir Vasin
Kim and Bobby Wainer
Joyce and Howard Wainer
Ginger and Rich Wald
Amy and Stuart Warner
Phil Warshauer
Stu Wassell
Herbert Wechsler
Muriel and Seymour Wechsler
Judy and Bob Wein
Shelly and Frank Weiner
JoAnn and Jim Weissman
Martin Weissman
Celia Wenig
Donna and Steve Willen
Cate and Bob Wineburg
Rhoda and Jay Winepol
Doreen and Donald Wolf
Marjorie and Mark Wolff
Maxine and Joseph Yager
Leonid and Victoriya Yefimov
Myrna and Harold Zimmerman
Madeline Zirlin

**of blessed memory*

Temple Emanuel Board of Trustees

Back Row: David Delman, Rabbi Fred Guttman, Desmond Sheridan, Marc Isaacson, Larry Gains, Paul Benson.

Middle Row: Tom Sloan, Michael Schiftan, Suzan Antin, Deb Schoenhoff,

Emily Nudelman, Andrew Brod, Brian Goldberg. **Front Row:** Andrea Petrarca, Amy Chrystal, Sherry Dickstein, Inge Guttman, Barry Frank, Craig Kabatchnick. Not shown: Joanne Bluethenthal, Gail Bernstein, Benjamin Cone, Jr., Catherine Magid, Dr. Robert Wainer.



Officers

Dr. Sherry DicksteinPresident
 Marc IsaacsonPresident Elect
 Joanne BluethenthalVP of Programming
 Dr. Andrew BrodVP of Education
 Tom SloanVP of Operations
 David DelmanTreasurer
 Dr. Lawrence GainsSecretary

Board of Trustees

Suzan AntinPre-School Chair
 Paul Benson
 Gail Bernstein
 Amy Chrystal
 Benjamin Cone, Jr.
 Barry FrankPast President
 Brian Goldberg
 Inge GuttmanBoard of Education Chair
 Craig KabatchnickBrotherhood President
 Catherine Magid
 Emily Nudelman
 Andrea PetrarcaSisterhood President
 Desmond SheridanFinance Committee Chair
 Michael Schiftan
 Dr. Deborah Schoenhoff.....Membership Chair
 Dr. Robert Wainer



Temple Emanuel Staff

Brenda Henley, John Gaddy, Dean Blackburn, Gail Hoffman, Michelle Westmoreland, Laura Bonasia. Not shown: Chris Loye.

Staff

Fred Guttman.....Rabbi
 Geri Newburge.....Rabbinic Intern
 Karen Dresser.....Religious School Director
 Janet HiattPre-School Director
 Gail Hoffman.....Administrator
 Brenda HenleyDirector of Congregant Services
 Laura BonasiaProgram Director
 Michele Westmoreland.....Secretary
 Dean BlackburnBookkeeper
 Daniel ThullTERS Administrative Assistant
 Mitchel SommersSoloist
 Lane RidenhourChoir Director
 Andy MockOrganist
 John GaddyFacilities
 Chris LoyeFacilities



Temple Emanuel Logo

In 1996, I was asked to submit design ideas for a temple logo to be approved by the board of directors. At the time, I was working on a project that involved a “monumental” sculpture or gates surrounding the entrance to a Torah Ark, and the present logo became a part of that project.

The heart of the project was to define Judaism. I began by asking the question: “How would you define Judaism in a single word response?” From more than one thousand responses, a picture of Judaism emerged: synagogue, Torah, prayer, community, Jewish anguish, tension, charity, unity, and family. I then attempted to incorporate these concepts into the present logo.

The Magen David symbol, that was first used as a symbol by the first Zionist Congress in 1897, is used to represent the Jewish people. The figures making up the star design represent and depict a community or family of persons, unified in prayer, love, charity, and the spirit of togetherness notwithstanding some anxiety and tension.

I showed the first rendering of the logo to my daughter, Debra Rotberg Tuggle, who is also an artist. She then fondly tweaked and polished the logo to its present finished state. I am pleased to have been asked to design the logo and believe it represents our temple and its mission.

Jay Rotberg

Donors to The Temple (Greene Street)

Barbara and Herman Cone, Jr.
 Sally and Robert Cone
 Rene and Thomas Cone
 Joan Falk and Herbert Falk, Jr.*
 Betsy and Richard Fox
 Barry Frank
 Dorothy and Stanley Frank
 Alice and Henry Isaacson
 Jill and Marc Isaacson
 Carolyn LeBauer
 Betty Roth
 Linda and Gerald Schafer
 Rose and Alfred Schiff
 Linda and Thomas Sloan
 Mitchel Sommers
 Joan and Richard Steele
 Kay Stern
 William Stern*
 Polly and Richard Strasser
 Leah Tannenbaum*
 Dorothy and Charles Weill, Jr.

**Of Blessed Memory*

Officers of The Temple (Greene Street)

President — Robert Cone
 Vice President — Henry Isaacson
 Secretary — Jeanne Tannenbaum
 Treasurer — Charles Weill, Jr.

Board Members

Edward Cone
 Robert Cone
 Herbert Falk, Jr.*
 Stanley Frank
 Henry Isaacson
 Kay Stern
 Leah Tannenbaum*
 Amy Thompson
 Charles Weill, Jr.

Library

Mission Statement

The library Media and Technology Center is an integral part of the instructional program of the Temple. Every student, teacher, and parent is provided a variety of materials, both print and non-print, on the history of Jews and Judaism. The materials are easily accessible at all times in order that students might develop their religious knowledge to its full potential.

First Librarian



Vicki Kilimanjaro

In the early 1960's Rabbi Joseph Asher, Rabbi Emeritus Frederick I. Rypins, and David T. Helberg, director of Temple Emanuel Religious School, were reorganizing the religious school curriculum. They decided that a library was needed as an integral part of the religious school curriculum.

The first organized library for Temple Emanuel Religious School was established in 1963 by Vickie Kilimanjaro. It was located upstairs behind the choir stand. There were mostly Jewish encyclopedias. Kilimanjaro, with input from teachers, selected and ordered books that were about Judaism and appropriate for a religious school curriculum. The Rabbis, Religious School director, and librarian wanted the students to know that in the library they could find the history of Jews and Judaism.

In 1980 the religious school moved to the Rypins Building. The collection had increased from about 90 books to nearly 1000. At this location, Kilimanjaro, along with the assistance of Dr. Sam and Ethel Silver, changed the book collection from the Dewey classification system to the Judaica system.

Kilimanjaro retired as librarian in 1984 after 21 years of service. She is currently volunteering with the organization of the new Jefferson Road Library.

Former Religious School Director



David T. Helberg,
Religious School Director,
1958-1977

"As we consider the history of our temple, we must not ignore the contributions those early 20th century Jews made by keeping alive their religious heritage. They set the stage to make Greensboro a friendly and hospitable city to a growing Jewish population. They organized and built a religious foundation that future generations, including this one, could enjoy and build upon."

David T. Helberg

David served as a teacher and Director of Temple Emanuel's Religious School for fifteen years and was active in the National Association of Temple Educators (NATE), serving 10 years as a member of its governing body, which honored him with a life membership.

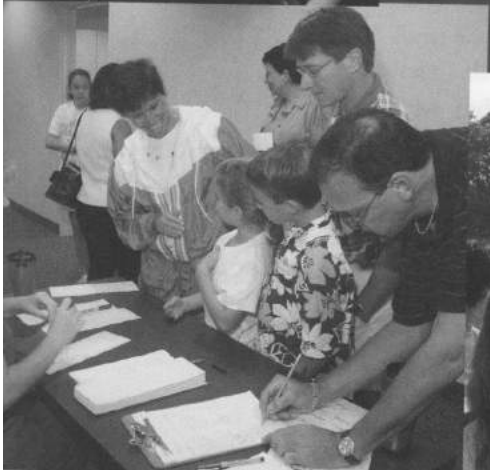
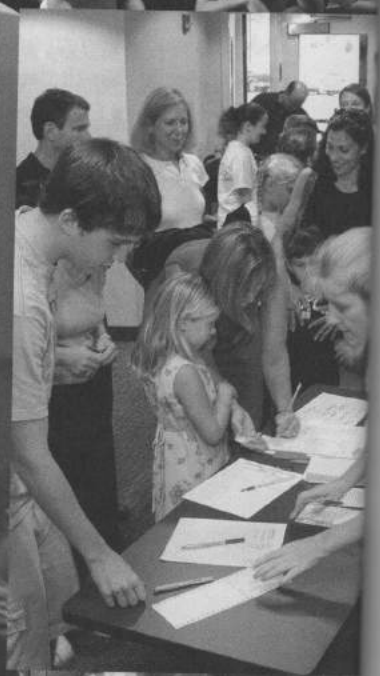

Temple Emanuel Religious School

Mission Statement

The mission of Temple Emanuel Religious School is to educate students in the ways of Torah in all its myriad expressions so that when they become adults, they will continue to walk in its path.

Temple Emanuel Religious School Board 2002-2004

Inge Guttmann, Chair

Heather Benson

Howard Benson

Susan Bond

Dr. Allan Goldfarb

Phyllis Klein

Howard Norwick

Haley Panzera

Stacey Papier

Paula Justice, Teacher Representative

Karen Dresser, Director of Education

Daniel Thull, Administrative Assistant



*Karen Dresser,
Director of Education*

TEACHERS

**Temple Emanuel
Religious School Student Body
2002-2003**

Pre-school

Paula Justice, Teacher

Ellie Aronson
Joel Benson
Noah Chaskin
Jessica Cohen
Charlie Freedman
Marley Lerner
Miriam McDonough
Rachel Pomerantz
Tori Rosen
Will Sagerdahl
Kati Schy
Sadie Stupar
Eric Van der Linden
Julia Weingold

Kindergarten

Rhonda Broder-Dunlevy, Teacher

Alyssa Altheimer
Lauren Bayer
Evan Benson
Celia Calhoun
Andrew Eckstein
Grant Falk
Eli Fribush
Sabrina Greer
Sydney Nadel
Eric Panzera
Jonas Procton
Jordan Robertson
Eli Schwartz
Elizabeth Segal
Jordon Tuders

1st Grade

Marion Gilligan, Teacher

Tyler Aluisio
Brandon Bayer
Kendall Marks
Aaron McDonough
Hannah Muurisep
Leah Podolle

Daniel Pomerantz
Sam Pulitzer
Jake Rosen
Julia Sagerdahl
Emily Schulman
Jake Shore
Samuel Silverstein
Max Weingold

2nd Grade

Tara Shore, Teacher

Ehren Caudill
Grant Chaskin
Sam Fribush
Erin Freedman
Rebecca Hogan
Jessica Papier
Garrett Peters
Andrew Regal
Alexa Schleien
Rebecca Schneiderman
Hunter Schott
Joshua Siar
Reid Smith
Erika Tolin
Annie Wainer
Kyle Warner

3rd Grade

*Kathy Fields/Shoshana Kosoff,
Teachers*

Matthew Aluisio
Marco Basile
Rebecca Bassell
Hunter Brown
Nathan Donnelly
Zack Draper
Brendan Dunlevy
Nathan Gerber
Jesse Korotitsch
Sophie Martin
Melanie Novick
Sydney Plovsky

Joshua Podolle
Eli Rosen
Zachary Roth
Ryan Schulman
Philip Michael Segal
Elliot Sheridan
Grey Shore
Jesse Steinberg
Claire Van der Linden

4th Grade

Kathy Fields/Shoshana Kosoff,

Tara Shore (mid-week), Teachers

Nicolette Aluisio
David Burick
Jacob Caudill
Evan Heiman
Lauren Kane
Daniel McDonough
Devin Peters
Alexander Procton
Jake Pulitzer
Carly Regal
Aaron Rosen
Alex Rotenstreich
Lucy Smith

5th Grade

*Avi Shavit, Mitchel Sommers (mid-
week), Teachers*

Carrie Brown
Miriam Brown
Elijah Cone
Jessica Cvijanovic
Lauren Freedman
Mara Goldberg
Lindsey Goodstat
Spencer Levy
Jillian Norwick
Jenna Schleien
Emily Siar
Lindsey Stiles
Jennifer Tolin

Joshua Van der Linden
Jayme Wainer

6th Grade

*Steve Robertson, Dahlia Halpern,
Jonathan Thull, Karen Dresser
(mid-week), Teachers*

Elle Basile
Katherine Bernstein
Trey Burke
Jonathan Davis
Jessica Donnelly
Ricki Draper
Stephen Gerber
Ryan Hogan
Allison Isaacson
Rebecca Kabatchnick
Jeremiah Kilimanjaro
Matthew Kusiak
Max Miller
Zack Panzera
Max Pulitzer
Joseph Rossabi
Adam Shore
Hannah Silverstein
Maddie Sperling
Sam Steinberg

7th Grade

*Adam Rubin, Geoff Baldwin,
Teachers*

Zachary Aberman
Benjamin Altheimer
Andrew Basile
Jason Blumenfeld
Nicky Brown
Derek Carr
Caroline Fields
Isaac Gains
Ryan Hogan
David Kaufman-Moore
Katie Kritzer
Keely MacDonald
Cameron Marks
Grayson Marks
Patrick McDonough
Stacey Novick
Rachel Plovsky
Zachary Pomer
Seth Shannin
Matthew Schechter

Craig Scheidlo
Ashley Wolf

8th Grade

*Rabbi Michael Pont, Karen Dresser,
Daniel Thull, Teachers*

Allison Camras
Zachary Chavez
Ally Chrystal
Amanda Donnelly
Matthew Gerber
Abbey Koenig
David Krantz
Derek Mars
Eddie Norwick
Leah Nudelman
Josh Rotenstreich
Addie Sellars
Graham Sheridan
Rebekah Shyloski
Shira Solomon
Juliet Sperling
Carrie Torn
Ashley Wainer
Adam Wassell

High School Teachers

*Rabbi Fred Guttman
Rabbi Eli Havivi
Rabbi Michael Pont
Karen Dresser, Director of Education
Dr. Tzipi Radonsky
Others from Community*

9th Grade

David Bond
Samantha Burke
Lizzie Chadbourne
Shaina Draper
Roberta Fields
Rachel Gains
Sarah Isaacson
Adam Kritzer
Anna Maltby
Sarah Nudelman
Josh Sommer
Ali Steinhorn
Emily Stupar
Any Tsent
Ashley Warshauer

10th Grade

Andrew Altheimer
David Bond
Jaylin Chrystal
Matthew Carr
Matthew Cvijanovic
Melanie Ellsweig
Yoav Guttman
Ryan Kabatchnick
Anna Kaplan
Natalie Kaplan
Zoe Lauenstein
Edward Levy
Samantha Levy
Matthew Marks
Rachel Meritt
Marissa Milstein
Hannah Norwick
Meagan Peters
Alex Pomer
Sarah Press
Holly Robertson
Shana Schwarz
Shaman Sellars
Kelsey Simmons

11th Grade

Rebekah Benson
Charles Bernstein
Nathan Blocker
Justin Dunlevy
Ben Miller
Audrey Pulitzer
Rachel Schifftan
Tal Shavit
Devon Sommers
Samantha Stiles
Michael Trotter
Hannah Wineburg
Margaret Wisco

12th Grade

Robert Bernstein
Evan Goldfarb
Stephanie Justice
Zachary Lauenstein
Andrew Marshall
Monica Petrarca
Ben Thompson
Stephanie Warshauer
Rachel Wolff





TEPS Mission Statement

TEPS is a developmental pre-school created to provide a loving, safe, nurturing Jewish pre-school experience. By providing a happy, enjoyable experience we hope to encourage a love of learning and school in all our children. We believe every child is precious and every one an individual to be treasured.

Temple Emanuel Pre-School Board 2002

Chairperson	Suzan Antin
Treasurer	Wendee Cutler
Secretary	Leah Strulson
Parent Rep/Hospitality	Andrea Calhoun
Fundraising	Kris Aronson
Marketing	Dana Smith
Judaic Consultant	Sandy Krellen
At-large	Jerry Plovsky
Director	Janet Hiatt
Advisor	Rabbi Fred Guttman



*Janet Hiatt,
Pre-school Director*



Temple Emanuel Sisterhood 2002-2004

Past Presidents Temple Emanuel Sisterhood 1989

*L to R: Joan Falk, Barbara Levy,
Mary Berkelhammer, Carolyn
LeBauer, Laura Weinstein,
Linda Silverstein, Elaine Marks.*

*Seated: Min Klein, Midge Pines,
Jane Rosen-Grandon, Leah
Tannenbaum, Marnie Ruskin.*

Mission Statement

Standing in the forefront of Jewish leadership, Temple Emanuel Sisterhood is devoted to strengthening our congregation, community and women's role in Reform Judaism. As a member of Sisterhood, we are a part of the international Women of Reform Judaism, the Federation of Temple Sisterhoods (WRJ), and the women's agency of Reform Judaism. We are committed to God, Torah, Israel, and Tikkun Olam. Temple Emanuel Sisterhood promotes the centrality of the family and congregation and respects the importance of the individual woman.

Temple Emanuel Sisterhood Board

President	Andrea Petrarca
Vice-President	Kris Aronson
Vice-President	Haley Panzera
Secretary	Heather Benson
Treasurer	Ann Gottman
Membership Treasurer	Muriel Dryer
Gift Shop Chair	Sue Weisenfeld
Social Action Chair	Erin Wolf
Rosh Chodesh Co-Chairs	Dori Jalazo
	Karen Dresser
Women's Retreat Chair	Donna Burick



Past Presidents of Sisterhood-NCJW circa 1951. *Mrs. Charles Weill, Sr., Mrs. Sidney J. Stern, Sr., Mrs. Benjamin Marks, Sr., Mrs. Herbert S. Falk, Sr., Mrs. J.R. Oettinger, Mrs. Bertram Bloch, Mrs. Hattie Weinberg, Mrs. A.M. Landau, Mrs. Al Klein, Mrs. Fred Rypins, Mrs. Milton Zauber, Mrs. Raymond Farber, Mrs. Milton Weinstein (Plant), Mrs. Marc Friedlaender.*



*Steve Bernstein,
Charlie Bernstein,
Charlie's friend
Rob Shepherd,
and
Larry Mars
(Archives)*

Temple Emanuel Brotherhood 2002-2004

Mission Statement

The purpose of the Brotherhood shall be to function as a supportive auxiliary of Temple Emanuel (hereinafter "Temple"), subject to the authority of the Board of Trustees of the Temple, in order to:

- stimulate Jewish religious activities;
- foster Jewish cultural and educational advancement among its membership, the Jewish community and the community at large;
- promote, through social interaction, the spirit of working together in friendship to achieve its goals;
- provide monetary support for the Temple; and
- undertake such activities in support of the Temple and Reform Judaism as deemed appropriate by the Brotherhood working together with the Temple and its affiliates and auxiliaries.

Temple Emanuel Brotherhood Board

President	Craig Kabatchnick
Vice Presidents	Don Eckstein
	Ron Krellen
	Keith Panzera
Secretary	Joel Goldstein
Treasurer	Paul Benson

Temple Emanuel Temple Youth of North Carolina

Mission Statement

Our purpose, as TEMTYNC (Temple Emanuel Temple Youth of North Carolina) is to learn and live by the ideals of Reform Judaism, promote Tikkun Olam (social action), and instill leadership values among Temple Emanuel youth.

TEMTYNC Board

Co-Presidents	Shaman Sellars and Yoav Guttman
Programming Vice President	Alex Pomer
Social Action Vice President	Holly Robertson
Religious and Cultural Vice President	Samantha Levy

Friendship Circle

Mission Statement

The Friendship Circle is a social gathering for adults, fifty-five years of age and older that is open to the entire community. The goal is fun, food, fellowship and special programs. The group is generously funded by the Tannenbaum-Sternberger Foundation.



Sylvia Ricketts



Marilyn Belenky



Leah Louise Tannenbaum

Gift Shop

The Temple Emanuel Gift Shop is now open in the beautiful new building at the Jefferson Road campus. The Gift Shop hours will be 9:30 to 12:30 on Sunday and, hopefully, at specific times Monday through Friday, those hours to be announced.



Min Klein

bat mitzvah invitations can be ordered at a 20% discount.

We invite you to stop by, browse and perhaps buy a little something. Remember...a gift from your gift shop is a gift to Temple!

*Sue Weisenfeld,
Gift Shop Chair*

Min Klein, who founded the gift shop over 30 years ago, started with \$100 and two display cases in the social hall of the Greene Street Temple. It became known as Min Klein's Korner and moved into the Rypins Building when it was built in 1979. The shop continues to be staffed with dedicated volunteers from the Sisterhood under the direction of Sue Weisenfeld. The Gift Shop offers a variety of Judaica items such as kiddush cups, candlesticks, mezzuzahs, menorahs, shofars, seder plates, talitot, kipot, jewelry, ketubahs, and original art work. Wedding as well as bar and



Karen Dresser, Director of Temple Emanuel Religious School, tutors Grayson Marks. Grayson and Cameron, his twin brother, were the first children to have a b'nai mitzvah in the new sanctuary. They are fifth generation Temple Emanuel members.



*Temple Emanuel
Ceremonial Court /
Succah, September,
2002*

Temple
Emanuel
Membership
2002

A

Aberman, Neil and Debbi
Abrahams, Dr. Stuart and Maryann
Abramson, Marty and Lara
Adelman, Dr. James and Ellen
Alfano, Deirdre
Alzheimer, Dr. Michael and Dr. Suzanne
Wagner
Aluisio, Dr. Frank and Karen
Anderson, Marilyn
Antin, Dr. Jonathan and Suzan
Aronson, Andy and Kris
Aronson, Dr. Richard and Dr.
Elizabeth

B

Backer, Richard
Baldwin, Geoffrey and Kristen
Barash, Irving
Bargebuhr, Gary and Laurie
Basile, Joseph and Michele
Basile, Dr. Vito and Carol
Bassell, Donald and Sharon
Bayer, Sanford
Bayer, Scott and Linda
Belenky, Neil and Marilyn
Belinsky, Cynthia
Belman, Leonid and Diana
Belman, Vladimir and Galina
Benjamin, Dr. Julian and Debra
Benson, Edward and Marilyn
Benson, Howard and Susan
Benson, Paul and Heather
Berger, Alan and Marcia
Berkelhammer, Billy and Ruth
Berkelhammer, Mary
Berlin, Ellis and Ellen
Bernstein, Martin and Shirley
Bernstein, Stephen and Gail
Beyder, Mark and Raisa
Birnbaum, Alex and Jessica
Blocker, Dennis and Adrienne
Bluethenthal, Jr., Arthur
Bluethenthal, Arthur and Joanne
Blumenfeld, Larry and Linda
Bochkis, Mikhail and Faina
Bogad, Steven and Sheryl
Bolot, Joe
Bonasia, Bob and Laura
Bond, Bob and Susan
Bost, Deborah

Boyette, Dr. Alan and Dr. Barbara
Brenowitz, Larry and Beverly
Breslow, George and Zeld
Bressler, Jordan and Jennifer
Brevda, Burton
Brod, Dr. Andrew
Broder-Dunlevy, Rhonda
Brown, Sylvia
Brown, Dr. Thomas and Caroline
Brunstetter, Roberta
Brushtin, Igor and Ester
Bunin, Zora
Burick, Paul and Donna
Burke, Ed and Carol

C

Calhoun, Jeff and Andrea
Camras, Irv and Marge
Camras, Larry and Sherry
Carr, Michael and Charlene
Cassell, Anna Lou
Cassell, Bill and Joann
Caudill, Mark and Ellen Gefen-Caudill
Cawn, Maurice and Sue
Chadbourne, Eugene and Emily
Changie, Robert and Bettie
Chandler, Robert and Marilyn
Chaskin, Adam and Regina
Chavez, Carlos and Robin
Christopher, Jana and Jerry
Chrystal, Dr. Glenn and Amy
Citron, Donald and Arlene
Clein, Robert and Selma
Cohen, Fred
Cohen, John and Sally
Cohen, Larry and Arlene
Colchamiro, Harvey
Colin, Dave and Shelly
Cone, Alan and Sally
Cone, Jr., Benjamin and Elizabeth
Cone, Bob and Sally
Cone, Ed and Lisa
Cone, Herman and Barbara
Cone, Tom and Rene
Cubell, Hilda
Curtis, Sylvia
Cutler, Ivan and Wendee
Cvijanovic, Vince and Ivy

D

Davis, Derek and Annette

Davis, Robert and Marlene
Delman, David and Jo
Detrano, Michael and Sarah
Dewey, Kent and Betty Kittner
Dintenfass, Jerry and Marion
Donnelly, James and Kimberly
Doobrow, Kent and Felicia
Draper, David and Rhonda
Dresser, Karen and Mack Godwin
Dreyer, Muriel

E

Eckstein, Don and Karen
Efremov, Dmitry and Yelena
Ehrenreich, Lillian
Eisenberg, Jay and Emily
Eisenberg, Ken and Ina
Eisenberg, Randall and Martha
Ellsweig, Evelyn
Ellsweig, Steven and Polly
Emerman, Ronald and Petra
Evans, David and Yvonne
Evans, Justin and Christine

F

Falk, Joan
Falk, Richard and Deena
Falk, Walter and Ginger
Fannon, Christopher and Amy
Faust, Harold and Belle
Feller, Howard and Anna
Fields, Alan and Katherine
Firestone, Steven and Harriette
Fischel, Burt and Myra
Fleishman, Joel and Linda
Fordham, Donna
Forman, Dick and Barbara
Foss, Stuart and Schmula
Fox, Dr. Richard and Betsy
Frank, Barry
Frank, Robert and Dianne
Frank, Stanley and Dorothy
Frank, William and Hughlene
Freedman, Brian and Kim
Freedman, Don and Kim
Fribush, Paul and Judi Magier
Friedman, Charles
Friedman, Marty and Gilda
Friedman, Milton and Marion
Futterman, Joel and Lauren

G

Gains, Larry and Leslie
Ganz, Dr. Charles and Joan
Garber, Jr., Stanley Howard
Gasalova, Yelena
Gerber, Mark
Gerber, Wayne and Debra
Gibbons, Anthony and Melinda
Gilligan, John and Marion
Gillis, Arthur and Caredith
Giltman, Annie
Gimpel, Robert and Syble Solomon
Ginsburg, Howard, and Kathy
Gitlin, David and Robin
Glick, Sheldon and Wilma
Goland, Alan and Marlene
Gold, Dr. Steven
Goldberg, Brian and Ria
Goldberg, Laurence and Pam
Goldberg, Robert and Terri
Goldfarb, Dr. Allan and Julie
Goldfarb, Celia
Goldklang, Shirley
Goldman, Erwin and Sandra
Goldman, Lena
Goldman, Rhoda
Goldstein, Joel
Goldstein, Robert and Diane
Goodman, Rob and Gillian
Goodstat, Howard
Goodstein, Ethel
Gordon, David and Sara
Gordon, Lance
Goss, Geraldine
Gottman, Jerry and Ann
Gottsegen, Dr. Daniel and Susan
Grandon, Dr. Gary and Dr. Jane
 Rosen-Grandon
Grasso, Maureen and Andrew Rosen
Green, Dr. Ed
Greenberg, Jack
Greenberg, Cheryl
Greene, Deborah
Greene-Brod, Lee
Greenfield, Sophie
Greer, Shawn Evans
Gross, Dr. Ned and Barbara Barrett
Gutman, Hank and Joyce
Guttman, Rabbi Fred and Nancy
Guttman, O.J. (Bob) and Inge
Guyes, Leonard and Rita

H

Hall, Jodie and Yael Nishry
Hall, Robert and Sheila
Halpern, Ronald and Gayle
Hanchrow, Flora
Harris, Frances
Harris, Richard and Sharon
Harrison, Nathan and Lenore
Hawkins, James and Beth
Helberg, David and Isabel
Heller, Dr. Joel and Sharon
Herman, Stanley and Nancy
Hiatt, David and Janet
Hines, Dr. Edward and Sharon
Hirschhaut, Bruce and Jackie
Hofbauer, Annette
Hogan, Hallee
Hollander, Dr. Edward and Susan
Homer, Dr. Leonard and Jan
Horowitz, Leo and Marcia
Hurewitz, David and Rodna
Hurwitz, Dr. Melvin and Charlotte
Hwasser, Erik and Stacey
Hyman, Jerry and Sue

I

Il'yasov, Il'yas and Rakhil
Isaacson, Henry and Alice
Isaacson, Irving
Isaacson, Marc and Jill Wilson
Israel, Archie and Adelaide
Isreal, Marvin

J

Jackson, Philip and Jill
Jacobs, H. Aaron and Rita
Jalazo, Paul and Dori
Johnson, Scott and Adrienne
Justice, Paula

K

Kabatchnick, Craig and Ruth
Kadoche, Haim and Edi
Kalinin, Vladimir and Aleutina
Kane, Andrew and Audrey
Kaplan, Darren and Sabina
Kaplan, Jack and Sheryl
Kaplan, Leonard and Tobee
Kaplan, Dr. Richard and Marguerite

Katz, Dr. Mark and Cathy
 Katzenstein, Alex and Betty
 Kazakov, Leonid and Genya
 Kilimanjaro, Sr., Jerry and Sybil
 Kilimanjaro, Dr. John and Vickie
 King, Carolyn
 Kislyanov, Mark and Yelena
 Klein, Phyllis
 Kleiner, Ron and Melissa
 Kobelev, Sergey and Natalya
 Koenig, Robert and LeeEllen
 Korotitsch, William and Caroline
 Klees
 Koshelev, Georgiy and Marina
 Krantz, Bradley and Dr. Jane Steiner
 Kraus, Rabbi David and Sonya
 Krellen, Ron and Sandra
 Kriegsman, Jack and Judy
 Kriegsman, Mel and Carmen
 Kriegsman, Dr. Robert and Rascha
 Kritzer, Dr. Randy and Judy Frederick
 Kusiak, Philip and Jeanne
 Kyazimova, Marina

L
 Labell, Nat
 LaBranche, James and Donna
 Lauenstein, Dr. Kurt and Dr. Sherry
 Dickstein
 Lavietes, Robert and Barbara
 LeBauer, Carolyn
 Lehrer, Steven and Lindell
 Leidner, Marilyn
 Leinwand, Helen
 Lerner, Bernice
 Lerner, Rich and Mandy
 Levin, Seymour and Carol
 Levy, Barbara
 Levy, David and Patricia
 Levy, Paul and Renee
 Levy, Richard and Jane
 Lieb, Arlene
 Lieb, Libby
 Lieb, Mickey and Estelle
 Liebling, Joel and Simone
 Liokymovich, Lev and Inessa
 Lovelace, Joel and Elisa
 Luchs, Stephen and Lynn

M
 MacDonald, Kevin and Lynn
 Mackler, Dr. Stephen and Leslie
 Magid, Catherine
 Magid, Lois
 Magitman, Samuil and Alexandra
 Malino, Dr. Jonathan and Dr. Sarah
 Malkin, Naum and Teresa
 Maltby, Cyndi
 Marks, Arnold and Naomi
 Marks, Jr., Ben and Elaine
 Marks, Dr. Edgar and Annemarie
 Marks, John
 Marks, Kelly and Nancy
 Marks, Stephen and Sigrid
 Marr, Charles and Sally
 Mars, Larry and Diane
 Marshall, Mike and Kay
 Martin, John and Susanne
 Masem, Paul and Caren
 May, Terry and Robin
 McDonough, Sharon
 McDonough, James
 McInnis, J.R. and Linda
 Medzveliy, Sergey and Lidiya
 Meritt, Scott and Haynes
 Metz, Scott and Leah
 Meyer, Stan and Anita
 Meyers, Natalie
 Miller, Lanny and Renee
 Miller, Michael and Elaine
 Miller, Stuart and Sylvia
 Miller, Warren and Martha
 Milstein, Ronald and Martha
 Mitkish, Kevin and Jill
 Moore, Dr. Wayne and Laura Kaufman
 Morrison, Joseph and Daniele Nichtern
 Mortensen, Loring and Lee
 Moss, Judi
 Murinson, Donald and Cynthia
 Muurisepp, Mark and Natalie
 Myatt, Emma and Jerry

N
 Nadel, Alan and Lydia
 Nagy, Gabor and Kally
 Neerman, Sam
 Nehmen, Joe and Susan
 Nepomnyashchiy, Mikhail
 Newman, Marion
 Norris, Carolyn

Norris, Millard and Denny
 Norwick, Howard and Heidi
 Novick, Lee and Nancy
 Nudelman, Norma
 Nudelman, Dr. Robert and Emily

O
 Ornstein, Miriam

P
 Palmer, Maureen
 Panzera, Keith and Haley
 Papier, Philip and Stacey
 Parish, Gail
 Parish, Lucy
 Peake, Michael and Gayle
 Peters, Blair and Judy
 Peterson, Michael and Denise
 Petrarca, Andrea and Brian
 Pines, Nicholas and Susie
 Pines, Bill and Midge
 Pinsker, Jerry
 Plovsky, Dr. Gerald and Dr. Deborah
 Schoenhoff
 Podolle, Mark and Faryl
 Pollack, Jack and Renee
 Pollet, Phillip
 Pomer, Barbara
 Pomerantz, Eric and Karen
 Poplavsky, Mikhail and Maryam
 Press, Reuben and Diane
 Procton, Brad and Cathy
 Procton, Bruce and Erica
 Pulitzer, Dr. Donald and Donna

R
 Rachlin, Robert and Annette
 Radonsky, Tzipi
 Rancer, Frank and Lisa
 Rancer, Karl
 Rapp, Ed and Gloria
 Rauch, Sr., Al and Lillian
 Rauch, Lowell and Kathy
 Regal, Dr. Norman and Laurie
 Reichelson, Sam and Cynthia
 Robertson, Stephen and Sara
 Robinson, Jim and Lauren
 Rogers, Dorothy
 Rokhlin, Yakov and Nasdezhd

Rosen, Andrew and Maureen Grasso
Rosen, Dr. Jefry and Michelle
Rosenbaum, Mark and Segrid
Rosenthal, Ila
Rossabi, Amiel and Judi
Rotberg, Jay and Keren
Rotenstreich, Kenneth and Amanda
Roth, Betty
Roth, Kathryn
Ruskin, Dr. Jerry and Marnie

S

Sagerdahl, Jerry and Sarah
Salvin, Bernice
Samet, Harry and Joan
Samet, Norman and Sylvia
Saperstein, Paul and Sara Lee
Schafer, Gerald and Linda
Schama, Mark and Andrea
Schechter, Jay and Cindy
Schechter, Pamela
Schiftan, Michael and Lynne
Schleien, Dr. Stuart and Dana
Schott, Michael and Ellin
Schulman, Brett and Laura
Schwartz, Norman and Jane
Schwartz, Sheila
Schwarz, Mark
Schwarz, Todd and Jennifer
Schy, Bill and Lisa Darmo
Segal, III, Philip and Kim
Segal, Corky
Seidel, Bernard
Semon, Brad and Randi
Senior, Paul and Tracy
Shackelford, Allan and Cindy
Shannin, Richard and Dr. Hope
 Gruber
Shavit, Avraham and Eilat
Sheldon, Melvin and Grace
Sheridan, Sr., Desmond and Ellen
Shore, Brian and Carol
Shore, Steven and Tara
Shyloski, Chester and Barbara
Siar, Dr. David and Dr. Sheryl
 Gottlieb-Siar
Silver, Ronald and Donna
Silver, Sheryl
Silvers, Janie
Silverstein, Gary and Betsy
Silverstein, Howard and Linda

Simel, Dr. Paul and Faye
Simmons, Gary and Susan
Simon, Marjorie
Sloan, Tom and Linda
Smigrod, Seymour and Deane
Smith, Ellen Spear and Douglas
Smith, Philip and Dana
Snitzer, Mort and Lois
Sohn, Arthur and Barbara
Solomon, Katrina
Solomon, Dr. Marshall and Dot
Solomon, Simon and Sondra
Sommer, Dr. Simone
Sommers, Mitchel
Sookne, Arnold and Ethel
Sperling, Mack and Ruth
Starr, Bill and Linda
Stein, Jeff and Chrissy
Steinberg, Mark
Steinhorn, Jerry and Ellyn
Stern, Katherine
Stern, Katherine and Mike Weaver
Stern, III, Sidney and Johannah
Stern, Steven and Georgianne
 Bogdan
Stiles, Kenneth and Patricia
Strasser, Buzz and Polly
Strulson, Barry and Leah
Stupar, Michael and Lynda
Summerell, Paul and Nancy

T

Tager, Kent
Tager, Peggy
Tanger, Stanley and Doris
Tanklevskiy, Ilya and Raisa
Tannenbaum, Jeanne
Tannenbaum, Dr. A. Raymond
Tannenbaum, Dr. Sigmund and Ellen
Tepper, Lauren
Theisen, George and Joan
Thompson, Joseph and Amy
Tolin, David and Teresa
Torn, Doug and Carole
Trace, Robert and Bonnie
Trotter, William and Elizabeth Lustig
Tuchman, Michael and Margaret
 Knowlas-Tuchman
Tuck, Marshall and Leslye
Tuttle, Matthew and Inna

V

Van der Linden, Jo and Barbara
Van der Linden, Scott and Mary

W

Wainer, Dr. Howard and Joyce
Wainer, Dr. Bobby and Kim
Wald, Rich and Ginger
Warner, Stuart and Amy
Warren, William
Warshauer, Philip
Wassell, Stuart
Wassell, Thelma
Waxman, Robert and Sandra
Wechsler, Herbert
Wechsler, Seymour and Muriel
Weill, Jr., Charles and Dorothy
Wein, Dr. Bob and Judy
Weinstein, Howard
Weinstein, Morey and Jane
Weisenfeld, Dr. Michael and Susan
Weissman, Dr. James and JoAnn
Wenig, Celia
Werner, Ellen
Willen, Dr. Steve and Donna
Williams, Brian and Jennifer Harris
Wineburg, Dr. Robert and Cate
Winopol, Jay and Rhoda
Winkelstein, Connie
Wittner, Jack and Colleen
Wolf, Donald and Doreen
Wolf, Erin
Wolff, Mark and Marjorie

Y

Yager, Joseph and Maxine
Yarborough, Thad and Sherrie
Yefimov, Leonid and Victoriay
Yoffe, Harvey
Yudin, Yevgeniy and Nina
Yudina, Marina

Z

Zimmerman, Harold and Myrna
Zubow, Emanuel

In Appreciation

We gratefully acknowledge the contributions of the following to the dedication program and to Temple Emanuel:

Bears, Balloons and Beyond (Renee and Lanny Miller)	Decor
Catering by Ellyn (Ellyn and Jerry Steinhorn)	Reception
Dori Jalazo Visions	Sanctuary Mezzuzah
Gary Fischer	Rabbi's Office Mezzuzah
Jay Rotberg	Entrance Mezzuzah

We also express gratitude to the following for helping underwrite the Temple Emanuel dedication book:

Benner and Fields, Inc.
Benjamin Cone, Jr.
Contract Steel
David Delman
North Star Painting Company
Sharp-Carter Corporation, Vic Cochran, President
Southern Plate Glass

Credits

Ina and Ken Eisenberg and family	Sanctuary flowers
Marvin Isreal	Photographs, including cover
Arnold Marks	Chairman of the Usher Committee (for 38 years)
Photo Innovations, David Rosen	Ground-breaking photograph
Philip Segal, III	Ceremonial Court photograph
Gefen Productions (Ellen Gefen and Mark Caudill)	Videography

Once again we are deeply grateful to our friends at the American Hebrew Academy for providing parking, transportation, and assistance with security. We are proud to be your neighbor.

Graphic Design by Jane Hughes Graphics
Printing by Printing Technology Inc., Vincent Albano



